



Bid Notice Abstract

Request for Quotation (RFQ)

Reference Number 12989193
Procuring Entity CARLOS HILADO MEMORIAL STATE UNIVERSITY
Title Procurement of Labor and Materials for the Repair and Enhancement of Student Center (OSAS) Phase 2 at Binalbagan Campus
Area of Delivery Negros Occidental

| | | | |
|--|---|------------------------------|---------------------|
| Solicitation Number: | RFQ 26-170 | Status | Pending |
| Trade Agreement: | Implementing Rules and Regulations | Associated Components | 5 |
| Procurement Mode: | Negotiated Procurement - Small Value Procurement (Sec. 53.9) | Bid Supplements | 0 |
| Classification: | Civil Works | Document Request List | 0 |
| Category: | Construction Projects | Date Published | 15/05/2026 |
| Approved Budget for the Contract: | PHP 350,000.00 | Last Updated / Time | 14/05/2026 15:36 PM |
| Delivery Period: | 60 Day/s | Closing Date / Time | 22/05/2026 17:00 PM |
| Client Agency: | | | |
| Contact Person: | Rowena De la Vida Prado Administrative Assistant II Mabini Street Talisay City Negros Occidental Philippines 6115 63-34-7120005 Ext.142 63-939-9296624 bac.sec@chmsu.edu.ph | | |

Description

Republic of the Philippines
 CARLOS HILADO MEMORIAL STATE UNIVERSITY
 Talisay City, Negros Occidental
 Mobile Phone Number: (0920) 583 3046
 bac.sec@chmsu.edu.ph

REQUEST FOR QUOTATION
 Page 1 of 11
 Date: MAY 13, 2026
 Quotation No. 26-170

Please quote your lowest price on the item/s listed below, stating the shortest time of delivery and submit your quotation duly signed by your representative not later than _____ in the return envelope attached herewith.

DR. MA. RIZA T. MANALO
 BAC Chairperson

NOTE:

- ALL ENTRIES MAY BE TYPEWRITTEN OR LEGIBLY HANDWRITTEN
- DELIVERY PERIOD WITHIN 60 CALENDAR DAYS
- WARRANTY SHALL BE FOR A PERIOD OF SIX (6) MONTHS FOR SUPPLIES & MATERIALS, ONE (1) YEAR FOR EQUIPMENT, FROM DATE OF ACCEPTANCE BY THE PROCURING ENTITY

4. PRICE VALIDITY SHALL BE FOR A PERIOD OF _____ CALENDAR DAYS
5. G-EPS REGISTRATION CERTIFICATE SHALL BE ATTACHED UPON SUBMISSION OF THE QUOTATION
6. BIDDERS SHALL SUBMIT ORIGINAL BROCHURES SHOWING CERTIFICATIONS OF THE PRODUCT BEING OFFERED

ITEM DESCRIPTION OF WORKS QTY. UNIT MATERIAL COST LABOR COST TOTAL COST

NO. Unit Cost Material Sub-Total Cost Unit Cost Labor Sub-Total Cost

ONE (1) LOT

LABOR AND MATERIALS FOR THE REPAIR AND ENHANCEMENT OF STUDENT CENTER (OSAS OFFICE) PHASE 2 AT CHMSU-BINALBAGAN CAMPUS

SCOPE OF WORKS

1.0 GENERAL REQUIREMENTS

- 1.1 Mobilization and Demobilization
- 1.2 Safety Occupational hazards
- 1.3 Site Clearing , Hauling and Grubbing
- 1.4 Scaffolding & Formworks
- 1.5 Demolition of existing walls, tiles, windows, and ceiling

2.0 CONCRETE AND MASONRY WORKS

- 2.1 CHB wall installation
- 2.2 Plastering Works
- 2.3 Lintel Beam

3.0 ARCHITECTURAL WORKS

- 3.1 Carpentry Works
- 3.2 Window/Glass Works
- 3.3 Supply and Installation Doors
- 3.4 Ceiling Works
- 3.5 Tile Works
- 3.6 Surface Preparation, Primer, & Double Top Coating (Interior & Exterior Walls, Columns, Ceiling, & Doors)

4.0 ELECTRICAL WORKS

5.0 PLUMBING WORKS

6.0 MISCELLANEOUS WORKS

6.1 FOR ALL OTHER ITEMS that are not included on listed Bill of Quantities in your Bid but are deemed necessary for the completion of the works and the delivery of the project.

BILL OF QUANTITIES

1.0 GENERAL REQUIREMENTS

- 1.1 Mobilization and Demobilization 1.00 Lot
 - 1.2 Safety Occupational hazards 1.00 Lot
 - 1.3 Site Clearing , Hauling and Grubbing 1.00 Lot
 - 1.4 Scaffolding & Formworks 1.00 Lot
 - 1.5 Demolition of existing walls, tiles, windows, and ceiling 1.00 Lot
- Sub-total, 1.0(GENERAL REQUIREMENTS)

2.0 CONCRETE AND MASONRY WORKS

- 2.1 CHB wall installation 11.36 sq.m.
 - 2.1.1 40 kg Portland Cement 9.00 bags
 - 2.1.2 Washed Sand 1.00 cu.m
 - 2.1.3 4" Concrete hollow blocks 142.00 pcs
 - 2.1.4 10mmØ x 6m deformed bars 8.00 lgths
 - 2.1.5 #16 G.I. Tie wires 1.00 Kgs.
 - 2.1.6 4"Ø steel cutting disc 1.00 pcs

Sub-total, 2.1 (CHB Wall Installation)
 - 2.2 Plastering Works 22.72 sq.m.
 - 2.2.1 40 kg Portland Cement 11.00 bags
 - 2.2.2 Washed Sand 1.00 cu.m

Sub-total, 2.2 (Plastering Works)
 - 2.3 Lintel Beam 0.16 cu.m
 - 2.3.1 40 kg Portland Cement 3.00 bags
 - 2.3.2 Mixing Sand 0.08 cu.m
 - 2.3.3 3/4" Gravel 0.16 cu.m
 - 2.3.4 10mmØ x 6m deformed bars 9.00 lgths
 - 2.3.5 #16 G.I. Tie wires 1.00 Kgs.

Sub-total, 2.3 (Lintel Beam)
- Sub-total, 2.0 (CONCRETE AND MASONRY WORKS)

3.0 ARCHITECTURAL WORKS

- 3.1 Carpentry Works
 - 3.1.1 Fluted Pvc Wall Panels 160x24x2950mm 13.00 pcs

Sub-total, 3.1 (Carpentry Works)
- 3.2 Window/Glass Works
 - 3.2.1 Fix and Sliding Window w/ 1/4" Thk glass w/ aluminum frame and accessories 6.00 sq.m.
 - 3.2.2 Sliding Window w/ 1/4" Thk glass w/ aluminum frame and accessories 2.16 sq.m.
 - 3.2.3 0.6m x 0.5m Vanity Mirror 0.30 sq.m.

Sub-total, 3.2 (Glass Works)
- 3.3 Supply and Installation of Doors
 - 3.3.1 (2.1 x 0.8m) Flush Door w/ w/ 2x4" Door Jamb and accessories 3.00 sets
 - 3.3.2 0.6m x 2.1m PVC door w/ door jamb and accessories 2.00 sets

Sub-total, 3.3 (Doors)

- 3.4 Ceiling Works 40.49 sq.m.
- 3.4.1 Fiber Cement Board 3.5mm Thk. 14.00 Pcs
- 3.4.2 Assorted Nails Size #1 #2 #3 #4 2.00 Kg
- 3.4.3 Double Furring 1"X2"X16' 0.5mm 40.00 Pcs
- 3.4.4 Carrying Channel 1"X2"X16', 0.8mm 12.00 Pcs
- 3.4.5 Wall angle 14.00 Pcs
- 3.4.6 Diamond Cutting Disc 4" 1.00 Pcs
- 3.4.7 Metal Cutting Disc 4" 1.00 Pcs
- 3.4.8 Blind Rivets 3/16" X1/2" 4.00 Box
- Sub-total, 3.4 (Ceiling Works)

- 3.5 Tile Works 8.24 m²
- 3.5.1 Glazed Tiles 30x60cm (See Plan Details) 39.00 pcs
- 3.5.2 Unglazed Tiles 30x30cm (See Plan Details) 20.00 pcs
- 3.5.3 Tile Grout 2kg 1.00 bag
- 3.5.4 Tile Adhesive 3.00 Bags
- 3.5.5 Fine sand 0.21 cu.m
- Sub-total, 3.5 (Tile Works)

- 3.6 Painting Works (Ceiling, Cabinets, & Chipping Works)
- 3.6.1 Surface Preparation, Primer, & Double Top Coating (Interior & Exterior Walls, Columns, Ceiling, & Doors) 149.37 Sq.m
- Sub-total, 3.6 (Painting Works)

Sub-total, 3.0 (ARCHITECTURAL WORKS)

4.0 ELECTRICAL WORKS

- 4.1 1.00 set
- 4.2 3.5mm² THHN Wire 50.00 mtrs
- 4.3 5.5mm² THHN Wire 1.00 roll
- 4.4 14mm² THHN Wire 10.00 mtrs
- 4.5 PVC Electrical Pipe 1/2" 15.00 pcs
- 4.6 Utility Box 11.00 pcs
- 4.7 Junction Box With Cover 5.00 pcs
- 4.8 Two-Gang Switch 2.00 units
- 4.9 One-Gang Switch 2.00 Unit
- 4.10 Duplex Convenience Outlet 11.00 pcs
- 4.11 ACU Outlets 2.00 pcs
- 4.12 LED Bulb 12W w/ LED Housing 5.00 set
- 4.13 LED Automatic Emergency Light 2.00 Unit

Sub-total, 4.0 (Electrical Works)

5.0 PLUMBING WORKS

- 5.1 Repair and adopt to existing Sanitary and Water line & Additional of Toilet Water line 1.00 lot
- 5.2 Dual Flush Toilet Fixture w/ Lavatory and accessories 1.00 set
- 5.3 Stainless Steel Lever Type Faucet 1.00 pc
- 5.4 Toilet Bidet 1.00 pc
- 5.5 4" x 4" Stainless Floor Drain 1.00 pc
- 5.6 PVC Solvent 400 CC 1.00 can
- 5.7 0.60m x 32mm Stainless Steel Toilet grab bar 1.00 pcs
- Sub-total, 5.0 (Plumbing Works)

6.0 MISCELLANEOUS WORKS

- 6.1 FOR ALL OTHER ITEMS that are not included on listed Bill of Quantities in your Bid but are deemed necessary for the completion of the works and the delivery of the project. 1.00 lot
- Sub-total, 6.0 (MISCELLANEOUS WORKS)

PROJECT DURATION: 60 CALENDAR DAYS

Note: Attach Certificate of Site Inspection

A. TOTAL DIRECT COST

B. CONSUMABLES:

C. SUPERVISION AND ADMINISTRATION:

D. TOTAL INDIRECT COST (B+C):

E. TOTAL COST (A+D)

F. VAT (12% OF ITEM E):

GRAND TOTAL OF PROJECT COST:

*****NOTHING FOLLOWS*****

TOTAL ABC = Php 350,000.00

PROCUREMENT OF LABOR AND MATERIALS FOR THE REPAIR AND ENHANCEMENT OF STUDENT CENTER (OSAS)

PHASE 2 - BINALBAGAN CAMPUS/ J. VERGARA (Campus Executive Director)

PR# 26-302-0421 04-21-26

MDS 142-101-26-04 04-22-26

Line Items

| Item No. | Product/Service Name | Description | Quantity | UOM | Budget (PHP) |
|----------|----------------------|--|----------|-----|--------------|
| 1 | ONE(1) | Labor and Materials for the Repair and Enhancement of Student Center (OSAS) Phase 2 at Binalbagan Campus | 1 | Lot | 350,000.00 |

Created by Rowena De la Vida Prado

Date Created 14/05/2026

The PhilGEPS team is not responsible for any typographical errors or misinformation presented in the system. PhilGEPS only displays information provided for by its clients, and any queries regarding the postings should be directed to the contact person/s of the concerned party.

© 2004-2026 DBM Procurement Service. All rights reserved.

[Help](#) | [Contact Us](#) | [Sitemap](#)



Republic of the Philippines
CARLOS HILADO MEMORIAL STATE UNIVERSITY
Talisay City, Negros Occidental
Mobile Phone Number: (0920) 583 3046
bac.sec@chmsu.edu.ph

REQUEST FOR QUOTATION

Page 1 of 11

Date: MAY 13, 2026
Quotation No. 26-170

Please quote your lowest price on the item/s listed below, stating the shortest time of delivery and submit your quotation, duly signed by your representative not later than _____ in the return envelope attached herewith.

DR. MA. RIZA T. MANALO
BAC Chairperson

NOTE:

1. ALL ENTRIES MAY BE TYPEWRITTEN OR LEGIBLY HANDWRITTEN
2. DELIVERY PERIOD WITHIN 60 CALENDAR DAYS
3. WARRANTY SHALL BE FOR A PERIOD OF SIX (6) MONTHS FOR SUPPLIES & MATERIALS, ONE (1) YEAR FOR EQUIPMENT, FROM DATE OF ACCEPTANCE BY THE PROCURING ENTITY
4. PRICE VALIDITY SHALL BE FOR A PERIOD OF _____ CALENDAR DAYS
5. G-EPS REGISTRATION CERTIFICATE SHALL BE ATTACHED UPON SUBMISSION OF THE QUOTATION
6. BIDDERS SHALL SUBMIT ORIGINAL BROCHURES SHOWING CERTIFICATIONS OF THE PRODUCT BEING OFFERED

| ITEM NO. | DESCRIPTION OF WORKS | QTY. | UNIT | MATERIAL COST | | LABOR COST | | TOTAL COST |
|------------|--|------|------|---------------|-------------------------|------------|----------------------|------------|
| | | | | Unit Cost | Material Sub-Total Cost | Unit Cost | Labor Sub-Total Cost | |
| | ONE (1) LOT | | | | | | | |
| | LABOR AND MATERIALS FOR THE REPAIR AND ENHANCEMENT OF STUDENT CENTER (OSAS OFFICE) PHASE 2 AT CHMSU-BINALBAGAN CAMPUS | | | | | | | |
| | SCOPE OF WORKS | | | | | | | |
| 1.0 | GENERAL REQUIREMENTS | | | | | | | |
| 1.1 | Mobilization and Demobilization | | | | | | | |
| 1.2 | Safety Occupational hazards | | | | | | | |
| 1.3 | Site Clearing , Hauling and Grubbing | | | | | | | |
| 1.4 | Scaffolding & Formworks | | | | | | | |
| 1.5 | Demolition of existing walls, tiles, windows, and ceiling | | | | | | | |
| 2.0 | CONCRETE AND MASONRY WORKS | | | | | | | |
| 2.1 | CHB wall installation | | | | | | | |

Released (BAC) _____ Date _____ By _____
Returned (Supplier) _____

Printed Name/Signature

Tel. No./Cellphone No.

Date



Republic of the Philippines
CARLOS HILADO MEMORIAL STATE UNIVERSITY
 Talisay City, Negros Occidental
 Mobile Phone Number: (0920) 583 3046
bac.sec@chmsu.edu.ph

REQUEST FOR QUOTATION

Page 2 of 11

Date: MAY 13, 2026
 Quotation No. 26-170

Please quote your lowest price on the item/s listed below, stating the shortest time of delivery and submit your quotation duly signed by your representative not later than _____ in the return envelope attached herewith.

DR. MA. RIZA T. MANALO
 BAC Chairperson

NOTE:

1. ALL ENTRIES MAY BE TYPEWRITTEN OR LEGIBLY HANDWRITTEN
2. DELIVERY PERIOD WITHIN 60 CALENDAR DAYS
3. WARRANTY SHALL BE FOR A PERIOD OF SIX (6) MONTHS FOR SUPPLIES & MATERIALS, ONE (1) YEAR FOR EQUIPMENT, FROM DATE OF OF ACCEPTANCE BY THE PROCURING ENTITY
4. PRICE VALIDITY SHALL BE FOR A PERIOD OF _____ CALENDAR DAYS
5. G-EPS REGISTRATION CERTIFICATE SHALL BE ATTACHED UPON SUBMISSION OF THE QUOTATION
6. BIDDERS SHALL SUBMIT ORIGINAL BROCHURES SHOWING CERTIFICATIONS OF THE PRODUCT BEING OFFERED

| ITEM NO. | DESCRIPTION OF WORKS | QTY. | UNIT | MATERIAL COST | | LABOR COST | | TOTAL COST |
|------------|--|------|------|---------------|-------------------------|------------|----------------------|------------|
| | | | | Unit Cost | Material Sub-Total Cost | Unit Cost | Labor Sub-Total Cost | |
| 2.2 | Plastering Works | | | | | | | |
| 2.3 | Lintel Beam | | | | | | | |
| 3.0 | ARCHITECTURAL WORKS | | | | | | | |
| 3.1 | Carpentry Works | | | | | | | |
| 3.2 | Window/Glass Works | | | | | | | |
| 3.3 | Supply and Installation Doors | | | | | | | |
| 3.4 | Ceiling Works | | | | | | | |
| 3.5 | Tile Works | | | | | | | |
| 3.6 | Surface Preparation, Primer, & Double Top Coating (Interior & Exterior Walls, Columns, Ceiling, & Doors) | | | | | | | |
| 4.0 | ELECTRICAL WORKS | | | | | | | |
| 5.0 | PLUMBING WORKS | | | | | | | |
| 6.0 | MISCELLANEOUS WORKS | | | | | | | |

Released (BAC) _____ Date _____ By _____
 Returned (Supplier) _____

 Printed Name/Signature

 Tel. No./Cellphone No.

 Date



Republic of the Philippines
CARLOS HILADO MEMORIAL STATE UNIVERSITY
 Talisay City, Negros Occidental
 Mobile Phone Number: (0920) 583 3046
bac.sec@chmsu.edu.ph

REQUEST FOR QUOTATION

Page 3 of 11

Date: MAY 13, 2026
 Quotation No. 26-170

Please quote your lowest price on the item/s listed below, stating the shortest time of delivery and submit your quotation duly signed by your representative not later than _____ in the return envelope attached herewith.

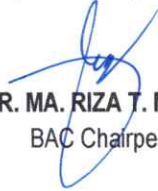
DR. MA. RIZA T. MANALO
 BAC Chairperson

NOTE:

1. ALL ENTRIES MAY BE TYPEWRITTEN OR LEGIBLY HANDWRITTEN
2. DELIVERY PERIOD WITHIN 60 CALENDAR DAYS
3. WARRANTY SHALL BE FOR A PERIOD OF SIX (6) MONTHS FOR SUPPLIES & MATERIALS, ONE (1) YEAR FOR EQUIPMENT, FROM DATE OF ACCEPTANCE BY THE PROCURING ENTITY
4. PRICE VALIDITY SHALL BE FOR A PERIOD OF _____ CALENDAR DAYS
5. G-EPS REGISTRATION CERTIFICATE SHALL BE ATTACHED UPON SUBMISSION OF THE QUOTATION
6. BIDDERS SHALL SUBMIT ORIGINAL BROCHURES SHOWING CERTIFICATIONS OF THE PRODUCT BEING OFFERED

| ITEM NO. | DESCRIPTION OF WORKS | QTY. | UNIT | MATERIAL COST | | LABOR COST | | TOTAL COST |
|------------|---|------|------|---------------|-------------------------|------------|----------------------|------------|
| | | | | Unit Cost | Material Sub-Total Cost | Unit Cost | Labor Sub-Total Cost | |
| 6.1 | FOR ALL OTHER ITEMS that are not included on listed Bill of Quantities in your Bid but are deemed necessary for the completion of the works and the delivery of the project. | | | | | | | |
| | BILL OF QUANTITIES | | | | | | | |
| 1.0 | GENERAL REQUIREMENTS | | | | | | | |
| 1.1 | Mobilization and Demobilization | 1.00 | Lot | | | | | |
| 1.2 | Safety Occupational hazards | 1.00 | Lot | | | | | |
| 1.3 | Site Clearing , Hauling and Grubbing | 1.00 | Lot | | | | | |
| 1.4 | Scaffolding & Formworks | 1.00 | Lot | | | | | |
| 1.5 | Demolition of existing walls, tiles, windows, and ceiling | 1.00 | Lot | | | | | |
| | Sub-total, 1.0(GENERAL REQUIREMENTS) | | | | | | | |

Date _____ By _____
 Released (BAC) _____
 Returned (Supplier) _____

 Printed Name/Signature

 Tel. No./Cellphone No.

 Date



Republic of the Philippines
CARLOS HILADO MEMORIAL STATE UNIVERSITY
 Talisay City, Negros Occidental
 Mobile Phone Number: (0920) 583 3046
bac.sec@chmsu.edu.ph

REQUEST FOR QUOTATION

Page 4 of 11

Date: MAY 13, 2026
 Quotation No. 26-170

Please quote your lowest price on the item/s listed below, stating the shortest time of delivery and submit your quotation duly signed by your representative not later than _____ in the return envelope attached herewith.

DR. MA. RIZA T. MANALO
 BAC Chairperson

NOTE:

1. ALL ENTRIES MAY BE TYPEWRITTEN OR LEGIBLY HANDWRITTEN
2. DELIVERY PERIOD WITHIN 60 CALENDAR DAYS
3. WARRANTY SHALL BE FOR A PERIOD OF SIX (6) MONTHS FOR SUPPLIES & MATERIALS, ONE (1) YEAR FOR EQUIPMENT, FROM DATE OF ACCEPTANCE BY THE PROCURING ENTITY
4. PRICE VALIDITY SHALL BE FOR A PERIOD OF _____ CALENDAR DAYS
5. G-EPS REGISTRATION CERTIFICATE SHALL BE ATTACHED UPON SUBMISSION OF THE QUOTATION
6. BIDDERS SHALL SUBMIT ORIGINAL BROCHURES SHOWING CERTIFICATIONS OF THE PRODUCT BEING OFFERED

| ITEM NO. | DESCRIPTION OF WORKS | QTY. | UNIT | MATERIAL COST | | LABOR COST | | TOTAL COST |
|------------|---|--------|-------|---------------|-------------------------|------------|----------------------|------------|
| | | | | Unit Cost | Material Sub-Total Cost | Unit Cost | Labor Sub-Total Cost | |
| 2.0 | CONCRETE AND MASONRY WORKS | | | | | | | |
| 2.1 | CHB wall installation | 11.36 | sq.m. | | | | | |
| 2.1.1 | 40 kg Portland Cement | 9.00 | bags | | | | | |
| 2.1.2 | Washed Sand | 1.00 | cu.m | | | | | |
| 2.1.3 | 4" Concrete hollow blocks | 142.00 | pcs | | | | | |
| 2.1.4 | 10mmØ x 6m deformed bars | 8.00 | lgths | | | | | |
| 2.1.5 | #16 G.I. Tie wires | 1.00 | Kgs. | | | | | |
| 2.1.6 | 4"Ø steel cutting disc | 1.00 | pcs | | | | | |
| | Sub-total, 2.1 (CHB Wall Installation) | | | | | | | |
| 2.2 | Plastering Works | 22.72 | sq.m. | | | | | |
| 2.2.1 | 40 kg Portland Cement | 11.00 | bags | | | | | |
| 2.2.2 | Washed Sand | 1.00 | cu.m | | | | | |
| | Sub-total, 2.2 (Plastering Works) | | | | | | | |

Released (BAC) _____ Date _____ By _____
 Returned (Supplier) _____

 Printed Name/Signature

 Tel. No./Cellphone No.

 Date



Republic of the Philippines
CARLOS HILADO MEMORIAL STATE UNIVERSITY
Talisay City, Negros Occidental
Mobile Phone Number: (0920) 583 3046
bac.sec@chmsu.edu.ph

REQUEST FOR QUOTATION

Page 5 of 11

Date: MAY 13, 2026
Quotation No. 26-170

Please quote your lowest price on the item/s listed below, stating the shortest time of delivery and submit your quotation duly signed by your representative not later than _____ in the return envelope attached herewith.

DR. MA. RIZA T. MANALO
BAC Chairperson

NOTE:

1. ALL ENTRIES MAY BE TYPEWRITTEN OR LEGIBLY HANDWRITTEN
2. DELIVERY PERIOD WITHIN 60 CALENDAR DAYS
3. WARRANTY SHALL BE FOR A PERIOD OF SIX (6) MONTHS FOR SUPPLIES & MATERIALS, ONE (1) YEAR FOR EQUIPMENT, FROM DATE OF ACCEPTANCE BY THE PROCURING ENTITY
4. PRICE VALIDITY SHALL BE FOR A PERIOD OF _____ CALENDAR DAYS
5. G-EPS REGISTRATION CERTIFICATE SHALL BE ATTACHED UPON SUBMISSION OF THE QUOTATION
6. BIDDERS SHALL SUBMIT ORIGINAL BROCHURES SHOWING CERTIFICATIONS OF THE PRODUCT BEING OFFERED

| ITEM NO. | DESCRIPTION OF WORKS | QTY. | UNIT | MATERIAL COST | | LABOR COST | | TOTAL COST |
|------------|--|-------|-------|---------------|-------------------------|------------|----------------------|------------|
| | | | | Unit Cost | Material Sub-Total Cost | Unit Cost | Labor Sub-Total Cost | |
| 2.3 | Lintel Beam | 0.16 | cu.m | | | | | |
| 2.3.1 | 40 kg Portland Cement | 3.00 | bags | | | | | |
| 2.3.2 | Mixing Sand | 0.08 | cu.m | | | | | |
| 2.3.3 | 3/4" Gravel | 0.16 | cu.m | | | | | |
| 2.3.4 | 10mmØ x 6m deformed bars | 9.00 | lghts | | | | | |
| 2.3.5 | #16 G.I. Tie wires | 1.00 | Kgs. | | | | | |
| | Sub-total, 2.3 (Lintel Beam) | | | | | | | |
| | Sub-total, 2.0 (CONCRETE AND MASONRY WORKS) | | | | | | | |
| 3.0 | ARCHITECTURAL WORKS | | | | | | | |
| 3.1 | Carpentry Works | | | | | | | |
| 3.1.1 | Fluted Pvc Wall Panels 160x24x2950mm | 13.00 | pcs | | | | | |
| | Sub-total, 3.1 (Carpentry Works) | | | | | | | |
| 3.2 | Window/Glass Works | | | | | | | |
| 3.2.1 | Fix and Sliding Window w/ 1/4" Thk glass w/ aluminum frame and accessories | 6.00 | sq.m. | | | | | |

Date _____ By _____

Released (BAC) _____

Returned (Supplier) _____

Printed Name/Signature

Tel. No./Cellphone No.

Date



Republic of the Philippines
CARLOS HILADO MEMORIAL STATE UNIVERSITY
 Talisay City, Negros Occidental
 Mobile Phone Number: (0920) 583 3046
bac.sec@chmsu.edu.ph

REQUEST FOR QUOTATION

Page 6 of 11

Date: MAY 13, 2026
 Quotation No. 26-170

Please quote your lowest price on the item/s listed below, stating the shortest time of delivery and submit your quotation duly signed by your representative not later than _____ in the return envelope attached herewith.

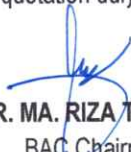
DR. MA. RIZA T. MANALO
 BAC Chairperson

NOTE:

1. ALL ENTRIES MAY BE TYPEWRITTEN OR LEGIBLY HANDWRITTEN
2. DELIVERY PERIOD WITHIN 60 CALENDAR DAYS
3. WARRANTY SHALL BE FOR A PERIOD OF SIX (6) MONTHS FOR SUPPLIES & MATERIALS, ONE (1) YEAR FOR EQUIPMENT, FROM DATE OF ACCEPTANCE BY THE PROCURING ENTITY
4. PRICE VALIDITY SHALL BE FOR A PERIOD OF _____ CALENDAR DAYS
5. G-EPS REGISTRATION CERTIFICATE SHALL BE ATTACHED UPON SUBMISSION OF THE QUOTATION
6. BIDDERS SHALL SUBMIT ORIGINAL BROCHURES SHOWING CERTIFICATIONS OF THE PRODUCT BEING OFFERED

| ITEM NO. | DESCRIPTION OF WORKS | QTY. | UNIT | MATERIAL COST | | LABOR COST | | TOTAL COST |
|------------|--|-------|-------|---------------|-------------------------|------------|----------------------|------------|
| | | | | Unit Cost | Material Sub-Total Cost | Unit Cost | Labor Sub-Total Cost | |
| 3.2.2 | Sliding Window w/ 1/4" Thk glass w/ aluminum frame and accessories | 2.16 | sq.m. | | | | | |
| 3.2.3 | 0.6m x 0.5m Vanity Mirror | 0.30 | sq.m. | | | | | |
| | Sub-total, 3.2 (Glass Works) | | | | | | | |
| 3.3 | Supply and Installation of Doors | | | | | | | |
| 3.3.1 | (2.1 x 0.8m) Flush Door w/ w/ 2x4" Door Jamb and accessories | 3.00 | sets | | | | | |
| 3.3.2 | 0.6m x 2.1m PVC door w/ door jamb and accessories | 2.00 | sets | | | | | |
| | Sub-total, 3.3 (Doors) | | | | | | | |
| 3.4 | Ceiling Works | 40.49 | sq.m. | | | | | |
| 3.4.1 | Fiber Cement Board 3.5mm Thk. | 14.00 | Pcs | | | | | |
| 3.4.2 | Assorted Nails Size #1 #2 #3 #4 | 2.00 | Kg | | | | | |
| 3.4.3 | Double Furring 1"X2"X16' 0.5mm | 40.00 | Pcs | | | | | |
| 3.4.4 | Carrying Channel 1"X2"X16', 0.8mm | 12.00 | Pcs | | | | | |
| 3.4.5 | Wall angle | 14.00 | Pcs | | | | | |

Date _____ By _____
 Released (BAC) _____
 Returned (Supplier) _____

Printed Name/Signature _____
 Tel. No./Cellphone No. _____
 Date _____



Republic of the Philippines
CARLOS HILADO MEMORIAL STATE UNIVERSITY
Talisay City, Negros Occidental
Mobile Phone Number: (0920) 583 3046
bac.sec@chmsu.edu.ph

REQUEST FOR QUOTATION

Page 7 of 11

Date: MAY 13, 2026
Quotation No. 26-170

Please quote your lowest price on the item/s listed below, stating the shortest time of delivery and submit your quotation duly signed by your representative not later than _____ in the return envelope attached herewith.

DR. MA. RIZA T. MANALO
BAC Chairperson

NOTE:

1. ALL ENTRIES MAY BE TYPEWRITTEN OR LEGIBLY HANDWRITTEN
2. DELIVERY PERIOD WITHIN 60 CALENDAR DAYS
3. WARRANTY SHALL BE FOR A PERIOD OF SIX (6) MONTHS FOR SUPPLIES & MATERIALS, ONE (1) YEAR FOR EQUIPMENT, FROM DATE OF ACCEPTANCE BY THE PROCURING ENTITY
4. PRICE VALIDITY SHALL BE FOR A PERIOD OF _____ CALENDAR DAYS
5. G-EPS REGISTRATION CERTIFICATE SHALL BE ATTACHED UPON SUBMISSION OF THE QUOTATION
6. BIDDERS SHALL SUBMIT ORIGINAL BROCHURES SHOWING CERTIFICATIONS OF THE PRODUCT BEING OFFERED

| ITEM NO. | DESCRIPTION OF WORKS | QTY. | UNIT | MATERIAL COST | | LABOR COST | | TOTAL COST |
|------------|--|--------|----------------|---------------|-------------------------|------------|----------------------|------------|
| | | | | Unit Cost | Material Sub-Total Cost | Unit Cost | Labor Sub-Total Cost | |
| 3.4.6 | Diamond Cutting Disc 4" | 1.00 | Pcs | | | | | |
| 3.4.7 | Metal Cutting Disc 4" | 1.00 | Pcs | | | | | |
| 3.4.8 | Blind Rivets 3/16" X1/2" | 4.00 | Box | | | | | |
| | Sub-total, 3.4 (Ceiling Works) | | | | | | | |
| 3.5 | Tile Works | 8.24 | m ² | | | | | |
| 3.5.1 | Glazed Tiles 30x60cm (See Plan Details) | 39.00 | pcs | | | | | |
| 3.5.2 | Unglazed Tiles 30x30cm (See Plan Details) | 20.00 | pcs | | | | | |
| 3.5.3 | Tile Grout 2kg | 1.00 | bag | | | | | |
| 3.5.4 | Tile Adhesive | 3.00 | Bags | | | | | |
| 3.5.5 | Fine sand | 0.21 | cu.m | | | | | |
| | Sub-total, 3.5 (Tile Works) | | | | | | | |
| 3.6 | Painting Works (Ceiling, Cabinets, & Chipping Works) | | | | | | | |
| 3.6.1 | Surface Preparation, Primer, & Double Top Coating (Interior & Exterior Walls, Columns, Ceiling, & Doors) | 149.37 | Sq.m | | | | | |

Released (BAC) _____ Date _____ By _____
Returned (Supplier) _____

Printed Name/Signature

Tel. No./Cellphone No.

Date



Republic of the Philippines
CARLOS HILADO MEMORIAL STATE UNIVERSITY
Talisay City, Negros Occidental
Mobile Phone Number: (0920) 583 3046
bac.sec@chmsu.edu.ph

REQUEST FOR QUOTATION

Page 8 of 11

Date: MAY 13, 2026
Quotation No. 26-170

Please quote your lowest price on the item/s listed below, stating the shortest time of delivery and submit your quotation duly signed by your representative not later than _____ in the return envelope attached herewith.

DR. MA. RIZA T. MANALO
BAC Chairperson

NOTE:

1. ALL ENTRIES MAY BE TYPEWRITTEN OR LEGIBLY HANDWRITTEN
2. DELIVERY PERIOD WITHIN 60 CALENDAR DAYS
3. WARRANTY SHALL BE FOR A PERIOD OF SIX (6) MONTHS FOR SUPPLIES & MATERIALS, ONE (1) YEAR FOR EQUIPMENT, FROM DATE OF ACCEPTANCE BY THE PROCURING ENTITY
4. PRICE VALIDITY SHALL BE FOR A PERIOD OF _____ CALENDAR DAYS
5. G-EPS REGISTRATION CERTIFICATE SHALL BE ATTACHED UPON SUBMISSION OF THE QUOTATION
6. BIDDERS SHALL SUBMIT ORIGINAL BROCHURES SHOWING CERTIFICATIONS OF THE PRODUCT BEING OFFERED

| ITEM NO. | DESCRIPTION OF WORKS | QTY. | UNIT | MATERIAL COST | | LABOR COST | | TOTAL COST |
|------------|---|-------|-------|---------------|-------------------------|------------|----------------------|------------|
| | | | | Unit Cost | Material Sub-Total Cost | Unit Cost | Labor Sub-Total Cost | |
| | Sub-total, 3.6 (Painting Works) | | | | | | | |
| | Sub-total, 3.0 (ARCHITECTURAL WORKS) | | | | | | | |
| 4.0 | ELECTRICAL WORKS | | | | | | | |
| 4.1 | | 1.00 | set | | | | | |
| 4.2 | 3.5mm ² THHN Wire | 50.00 | mtrs | | | | | |
| 4.3 | 5.5mm ² THHN Wire | 1.00 | roll | | | | | |
| 4.4 | 14mm ² THHN Wire | 10.00 | mtrs | | | | | |
| 4.5 | PVC Electrical Pipe 1/2" | 15.00 | pcs | | | | | |
| 4.6 | Utility Box | 11.00 | pcs | | | | | |
| 4.7 | Junction Box With Cover | 5.00 | pcs | | | | | |
| 4.8 | Two-Gang Switch | 2.00 | units | | | | | |
| 4.9 | One-Gang Switch | 2.00 | Unit | | | | | |
| 4.10 | Duplex Convenience Outlet | 11.00 | pcs | | | | | |
| 4.11 | ACU Outlets | 2.00 | pcs | | | | | |

Released (BAC) _____ Date _____ By _____
Returned (Supplier) _____

Printed Name/Signature

Tel. No./Cellphone No.

Date



Republic of the Philippines
CARLOS HILADO MEMORIAL STATE UNIVERSITY
Talisay City, Negros Occidental
Mobile Phone Number: (0920) 583 3046
bac.sec@chmsu.edu.ph

REQUEST FOR QUOTATION

Page 9 of 11

Date: MAY 13, 2026
Quotation No. 26-170

Please quote your lowest price on the item/s listed below, stating the shortest time of delivery and submit your quotation duly signed by your representative not later than _____ in the return envelope attached herewith.

DR. MA. RIZA T. MANALO
BAC Chairperson

NOTE:

1. ALL ENTRIES MAY BE TYPEWRITTEN OR LEGIBLY HANDWRITTEN
2. DELIVERY PERIOD WITHIN 60 CALENDAR DAYS
3. WARRANTY SHALL BE FOR A PERIOD OF SIX (6) MONTHS FOR SUPPLIES & MATERIALS, ONE (1) YEAR FOR EQUIPMENT, FROM DATE OF ACCEPTANCE BY THE PROCURING ENTITY
4. PRICE VALIDITY SHALL BE FOR A PERIOD OF _____ CALENDAR DAYS
5. G-EPS REGISTRATION CERTIFICATE SHALL BE ATTACHED UPON SUBMISSION OF THE QUOTATION
6. BIDDERS SHALL SUBMIT ORIGINAL BROCHURES SHOWING CERTIFICATIONS OF THE PRODUCT BEING OFFERED

| ITEM NO. | DESCRIPTION OF WORKS | QTY. | UNIT | MATERIAL COST | | LABOR COST | | TOTAL COST |
|------------|--|------|------|---------------|-------------------------|------------|----------------------|------------|
| | | | | Unit Cost | Material Sub-Total Cost | Unit Cost | Labor Sub-Total Cost | |
| 4.12 | LED Bulb 12W w/ LED Housing | 5.00 | set | | | | | |
| 4.13 | LED Automatic Emergency Light | 2.00 | Unit | | | | | |
| | Sub-total, 4.0 (Electrical Works) | | | | | | | |
| 5.0 | PLUMBING WORKS | | | | | | | |
| 5.1 | Repair and adopt to existing Sanitary and Water line & Additional of Toilet Water line | 1.00 | lot | | | | | |
| 5.2 | Dual Flush Toilet Fixture w/ Lavatory and accessories | 1.00 | set | | | | | |
| 5.3 | Stainless Steel Lever Type Faucet | 1.00 | pc | | | | | |
| 5.4 | Toilet Bidet | 1.00 | pc | | | | | |
| 5.5 | 4" x 4" Stainless Floor Drain | 1.00 | pc | | | | | |
| 5.6 | PVC Solvent 400 CC | 1.00 | can | | | | | |
| 5.7 | 0.60m x 32mm Stainless Steel Toilet grab bar | 1.00 | pcs | | | | | |

Released (BAC) _____ Date _____ By _____
Returned (Supplier) _____

Printed Name/Signature

Tel. No./Cellphone No.

Date



Republic of the Philippines
CARLOS HILADO MEMORIAL STATE UNIVERSITY
 Talisay City, Negros Occidental
 Mobile Phone Number: (0920) 583 3046
bac.sec@chmsu.edu.ph

REQUEST FOR QUOTATION

Page 10 of 11

Date: MAY 13, 2026
 Quotation No. 26-170

Please quote your lowest price on the item/s listed below, stating the shortest time of delivery and submit your quotation duly signed by your representative not later than _____ in the return envelope attached herewith.

DR. MA. RIZA T. MANALO
 BAC Chairperson

NOTE:

1. ALL ENTRIES MAY BE TYPEWRITTEN OR LEGIBLY HANDWRITTEN
2. DELIVERY PERIOD WITHIN 60 CALENDAR DAYS
3. WARRANTY SHALL BE FOR A PERIOD OF SIX (6) MONTHS FOR SUPPLIES & MATERIALS, ONE (1) YEAR FOR EQUIPMENT, FROM DATE OF ACCEPTANCE BY THE PROCURING ENTITY
4. PRICE VALIDITY SHALL BE FOR A PERIOD OF _____ CALENDAR DAYS
5. G-EPS REGISTRATION CERTIFICATE SHALL BE ATTACHED UPON SUBMISSION OF THE QUOTATION
6. BIDDERS SHALL SUBMIT ORIGINAL BROCHURES SHOWING CERTIFICATIONS OF THE PRODUCT BEING OFFERED

| ITEM NO. | DESCRIPTION OF WORKS | QTY. | UNIT | MATERIAL COST | | LABOR COST | | TOTAL COST |
|------------|---|------|------|---------------|-------------------------|------------|----------------------|------------|
| | | | | Unit Cost | Material Sub-Total Cost | Unit Cost | Labor Sub-Total Cost | |
| | Sub-total, 5.0 (Plumbing Works) | | | | | | | |
| 6.0 | MISCELLANEOUS WORKS | | | | | | | |
| 6.1 | FOR ALL OTHER ITEMS that are not included on listed Bill of Quantities in your Bid but are deemed necessary for the completion of the works and the delivery of the project. | 1.00 | lot | | | | | |
| | Sub-total, 6.0 (MISCELLANEOUS WORKS) | | | | | | | |
| | PROJECT DURATION: 60 CALENDAR DAYS | | | | | | | |
| | Note: Attach Certificate of Site Inspection | | | | | | | |
| | A. TOTAL DIRECT COST | | | | | | | |
| | B. CONSUMABLES: | | | | | | | |
| | C. SUPERVISION AND ADMINISTRATION: | | | | | | | |
| | D. TOTAL INDIRECT COST (B+C): | | | | | | | |
| | E. TOTAL COST (A+D) | | | | | | | |

Released (BAC) _____ Date _____ By _____
 Returned (Supplier) _____

 Printed Name/Signature

 Tel. No./Cellphone No.

 Date



Republic of the Philippines
CARLOS HILADO MEMORIAL STATE UNIVERSITY
 Talisay City, Negros Occidental
 Mobile Phone Number: (0920) 583 3046
bac.sec@chmsu.edu.ph

REQUEST FOR QUOTATION

Page 11 of 11

Date: MAY 13, 2026
 Quotation No. 26-170

Please quote your lowest price on the item/s listed below, stating the shortest time of delivery and submit your quotation duly signed by your representative not later than _____ in the return envelope attached herewith.

DR. MA. RIZA T. MANALO
 BAC Chairperson

NOTE:

1. ALL ENTRIES MAY BE TYPEWRITTEN OR LEGIBLY HANDWRITTEN
2. DELIVERY PERIOD WITHIN 60 CALENDAR DAYS
3. WARRANTY SHALL BE FOR A PERIOD OF SIX (6) MONTHS FOR SUPPLIES & MATERIALS, ONE (1) YEAR FOR EQUIPMENT, FROM DATE OF ACCEPTANCE BY THE PROCURING ENTITY
4. PRICE VALIDITY SHALL BE FOR A PERIOD OF _____ CALENDAR DAYS
5. G-EPS REGISTRATION CERTIFICATE SHALL BE ATTACHED UPON SUBMISSION OF THE QUOTATION
6. BIDDERS SHALL SUBMIT ORIGINAL BROCHURES SHOWING CERTIFICATIONS OF THE PRODUCT BEING OFFERED

| ITEM NO. | DESCRIPTION OF WORKS | QTY. | UNIT | MATERIAL COST | | LABOR COST | | TOTAL COST |
|----------|--|------|------|---------------|-------------------------|------------|----------------------|------------|
| | | | | Unit Cost | Material Sub-Total Cost | Unit Cost | Labor Sub-Total Cost | |
| | F. VAT (12% OF ITEM E): | | | | | | | |
| | GRAND TOTAL OF PROJECT COST: | | | | | | | |
| | *****NOTHING FOLLOWS***** | | | | | | | |
| | TOTAL ABC = Php 350,000.00 | | | | | | | |
| | PROCUREMENT OF LABOR AND MATERIALS FOR THE REPAIR AND ENHANCEMENT OF STUDENT CENTER (OSAS OFFICE) PHASE 2 - BINALBAGAN CAMPUS/ J. VERGARA (Campus Executive Director) | | | | | | | |
| | PR# 26-302-0421 04-21-26 | | | | | | | |
| | MDS 142-101-26-04 04-22-26 | | | | | | | |
| | | | | | | | | |
| | | | | | | | | |
| | | | | | | | | |
| | | | | | | | | |

Released (BAC) _____ Date _____ By _____
 Returned (Supplier) _____

 Printed Name/Signature

 Tel. No./Cellphone No.

 Date

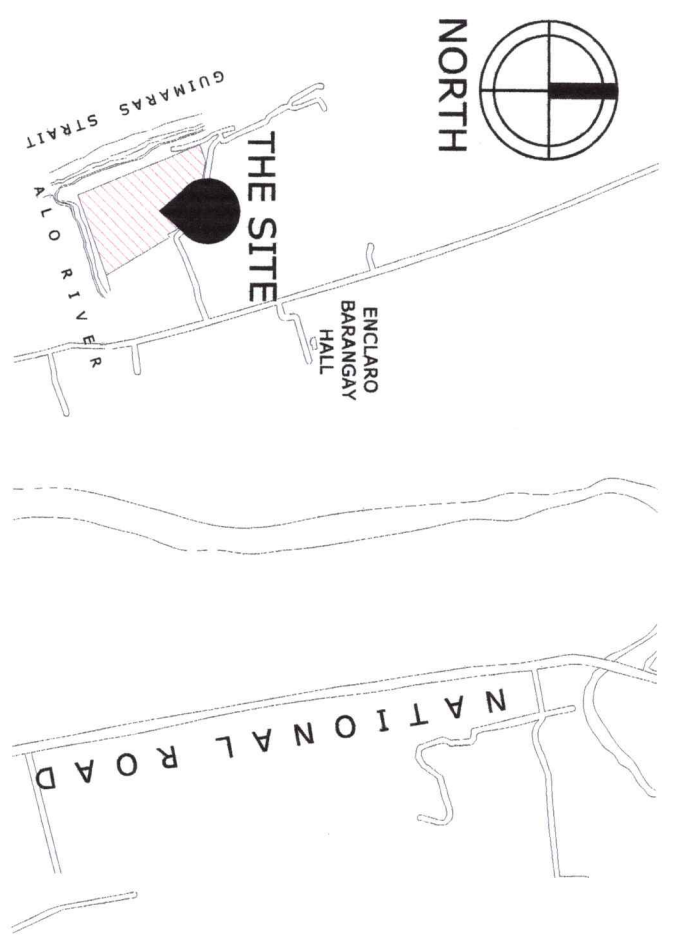

1 SITE VICINITY MAP
SCALE NOT TO SCALE

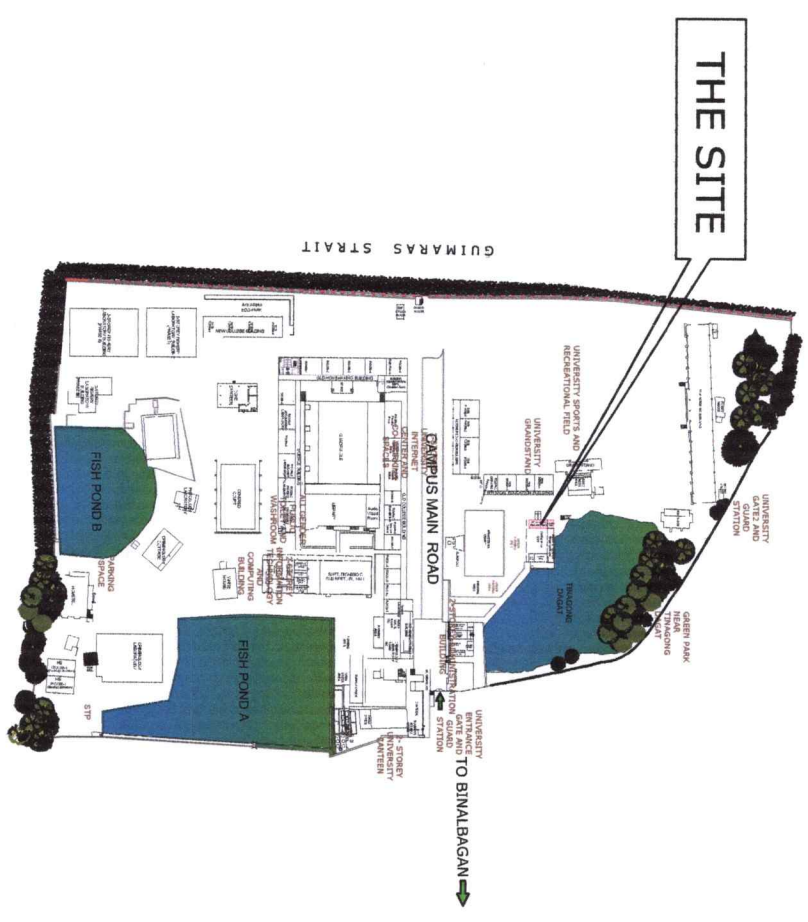

2 SITE DEVELOPMENT PLAN
SCALE NOT TO SCALE









3 PERSPECTIVE
SCALE NOT TO SCALE



TABLE OF CONTENTS

| SHEET | TITLE |
|-------|---|
| CS | ARCHITECTURAL |
| CS | 1. VICINITY MAP |
| CS | 2. SITE DEVELOPMENT PLAN |
| CS | 3. PERSPECTIVE |
| A-1 | INTERIOR PERSPECTIVE |
| A-2 | REMOVAL/DEMOLITION OF EXISTING STRUCTURE |
| A-3 | EXISTING FLOOR PLAN |
| A-4 | PROPOSED FLOOR PLAN |
| A-5 | 1. SECTION THRU-AA |
| A-5 | 2. SECTION THRU-BB |
| A-5 | 3. SECTION THRU-CC |
| A-5 | 4. SECTION THRU-DD |
| A-5 | 5. SECTION THRU-EE |
| A-5 | 6. SECTION THRU-FF |
| A-5 | 7. SECTION THRU-GG |
| A-5 | 8. SECTION THRU-HH |
| A-6 | 1. SCHEDULE OF DOORS AND WINDOWS |
| A-6 | 2. SCHEDULE OF WALL AND DOOR FINISHES |
| A-6 | 3. FLOOR TILES LAYOUT PLAN |
| A-6 | 4. HARDIFLEX AND METAL FURRING BLOW-UP DETAIL |
| A-6 | 5. LINTEL BEAM DETAIL |
| E-1 | ELECTRICAL |
| E-1 | 1. GENERAL NOTES |
| E-1 | 2. LEGEND |
| E-1 | 3. SCHEDULE OF LOADS |
| E-1 | 4. VICINITY MAP |
| E-1 | 5. SINGLE LINE DIAGRAM |
| E-1 | 6. LIGHTING LAYOUT PLAN |
| E-1 | 7. POWER LAYOUT PLAN |
| E-1 | PLUMBING |
| P-1 | 1. GENERAL NOTES |
| P-1 | 2. VICINITY MAP |
| P-1 | 3. LEGEND |
| P-1 | 4. SANITARY LINE LAYOUT PLAN |
| P-1 | 5. WATER LINE LAYOUT PLAN |

| | | | |
|--|--|--|--|
|  Republic of the Philippines CARLOS HILADO MEMORIAL STATE UNIVERSITY Negros Occidental | | PROJECT MANAGEMENT UNIT | |
| PROJECT TITLE: REPAIR AND ENHANCEMENT OF STUDENT CENTER (OSAS OFFICE) PHASE 2 AT CHMSU-BINALABAGAN CAMPUS | | ENDORSED BY:  JOHELLE B. YENGARA, EDD. EXECUTIVE DIRECTOR, BINALABAGAN | |
| PROJECT LOCATION: BINALABAGAN CAMPUS | | PREPARED BY:  MALEON VILLALUNA DRAFTSMAN, PAU- BINALABAGAN CAMPUS | |
| CHECKED BY:  ANABEL M. SILIAT, Jap PROJECT DEVELOPMENT OFFICER II, PAU | | ENGR. JOHN CARLO F. GANON CIVIL ENGINEER, PAU- BINALABAGAN CAMPUS | |
| RECOMMENDING APPROVAL:  JAY B. ESTRELLA, EDD. DIRECTOR, PROJECT MANAGEMENT UNIT | | ENGR. JESSE O. CHAVEZ PROJECT DEVELOPMENT OFFICER III, PAU | |
| APPROVED BY:  NORBERTO P. MANGULABNAN, Ph.D. SUC PRESIDENT III | | SHEET NO: CS | |
| SHEET NO: CS | | PAGE NO: | |



WORKING SPACE/RECEIVING AREA



OFFICE

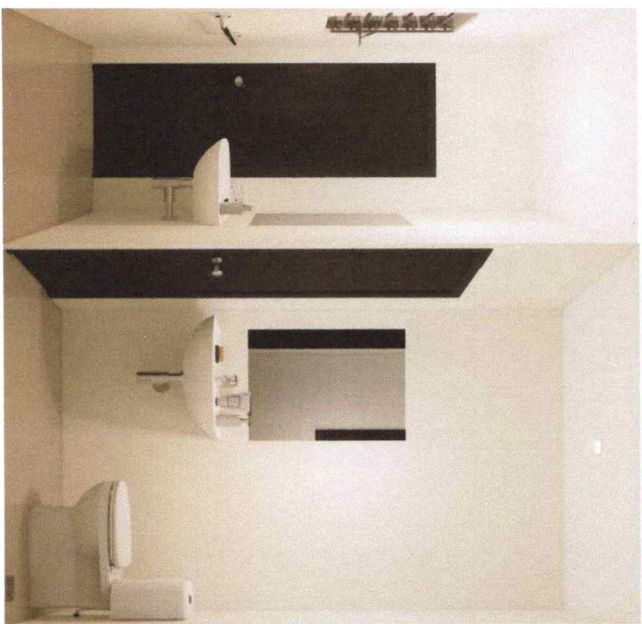

COMFORT ROOM



WORKING SPACE



OFFICE

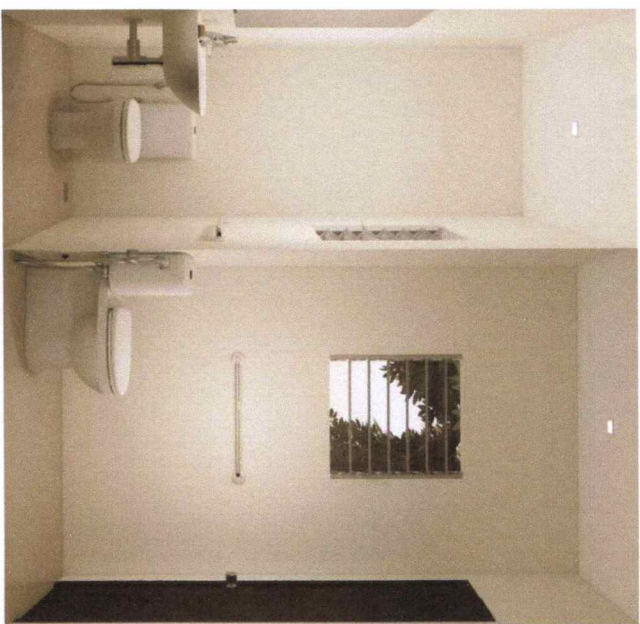

COMFORT ROOM



INTERIOR PERSPECTIVE
SCALE
NOT TO SCALE

| | | | | | | | | | | | | | | | | | |
|---|--|--|--|---|--|--|--|--|--|---|--|---|--|---|--|--|--|
|  <p>Republic of the Philippines CARLOS HILADO MEMORIAL STATE UNIVERSITY Negros Occidental</p> | | <p>PROJECT TITLE: REPAIR AND ENHANCEMENT OF STUDENT CENTER (OSAS OFFICE) PHASE 2 AT CHMSU-BINALBAGAN CAMPUS</p> | | <p>ENDORSED BY: <i>Joe Velle B. Vergara, Edd.</i> EXECUTIVE DIRECTOR, BINALBAGAN</p> | | <p>PREPARED BY: <i>Ma Leonida M. Villaluna</i> DRAFTSMAN, PMU- BINALBAGAN CAMPUS ENGR. JOHN CARLO F. GANON CIVIL ENGINEER, PMU- BINALBAGAN CAMPUS</p> | | <p>CHECKED BY: <i>Arnel M. Sulat, Sup</i> PROJECT DEVELOPMENT OFFICER II, PMU ENGR. MARVIN S. CHAVEZ PROJECT DEVELOPMENT OFFICER III, PMU</p> | | <p>RECOMMENDING APPROVAL: <i>Jan-Jun J. Mardquez</i> DIRECTOR, PROJECT MANAGEMENT UNIT</p> | | <p>APPROVED BY: <i>Jay B. Espelias, Edd.</i> VICE PRESIDENT FOR ADMINISTRATION AND FINANCE</p> | | <p>APPROVED BY: <i>Norberto P. Mangualabnan, Ph.D.</i> SUC PRESIDENT III</p> | | <p>SHEET NO. / PAGE NO. A / 1 / 6</p> | |
|---|--|--|--|---|--|--|--|--|--|---|--|---|--|---|--|--|--|

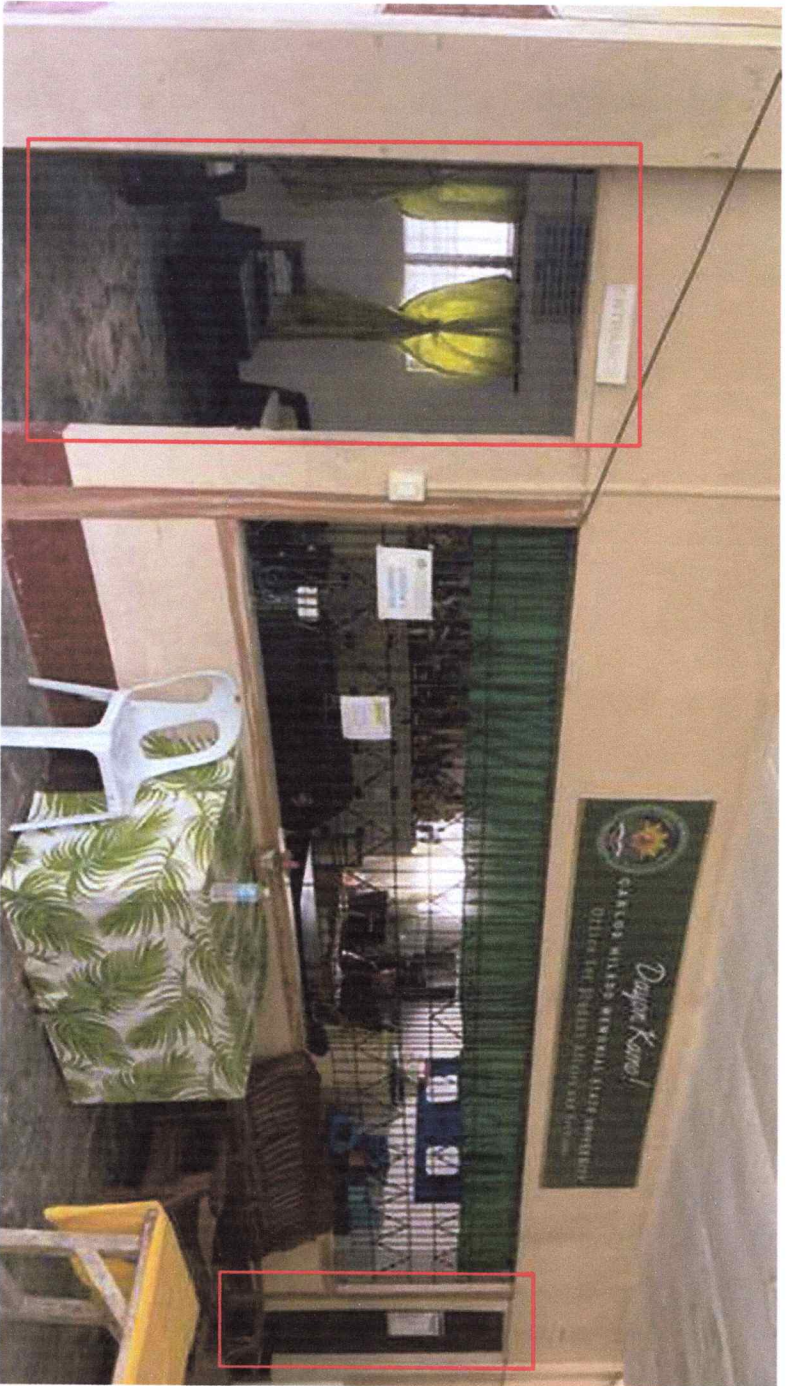

MAIN / EXIT DOOR



PROPOSED DOOR FOR COMFORT ROOM



COMFORT ROOM

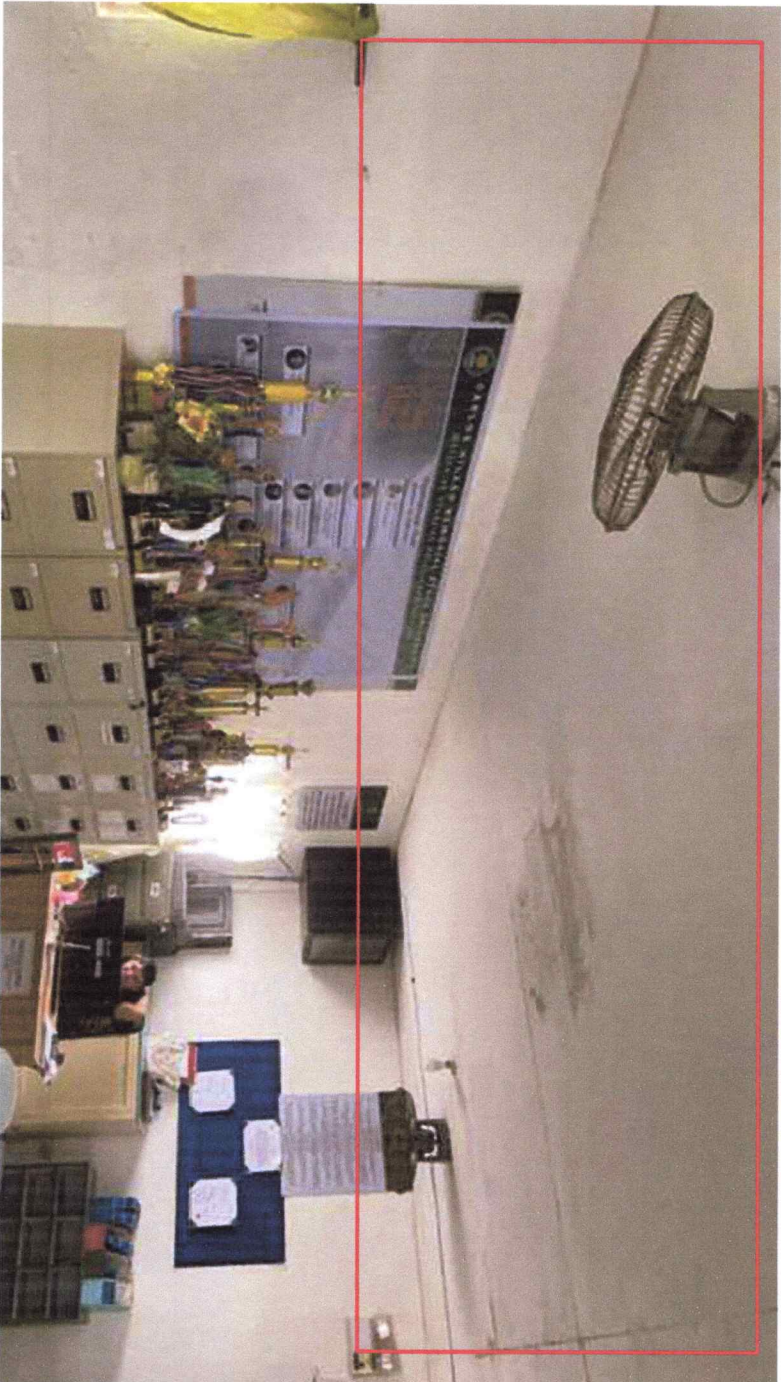

C E I L I N G



W I N D O W

1
A2

REMOVAL/DEMOLITION OF EXISTING STRUCTURE
SCALE NOT TO SCALE

PROJECT TITLE:

REPAIR AND ENHANCEMENT OF STUDENT CENTER (OSAS OFFICE) PHASE 2 AT CHMSU-BINALBAGAN CAMPUS

ENDORSED BY:

JOEVELLE B. VERGARA, EDD,
EXECUTIVE DIRECTOR, BINALBAGAN

PREPARED BY:

MALDONADO, PAUL BINALBAGAN CAMPUS
ENGR. JOY CARLO F. GANON
CIVIL ENGINEER, PAU- BINALBAGAN CAMPUS

CHECKED BY:

APRIL MARY S. SULTAN, UAP
PROJECT DEVELOPMENT OFFICER II, PAU
ENGR. DAVID O. CHAVEZ
PROJECT DEVELOPMENT OFFICER III, PAU

RECOMMENDING APPROVAL:

ENGR. JUN J. MARQUEZ
DIRECTOR, PROJECT MANAGEMENT UNIT

APPROVED BY:

JAY B. ESKELLAS, EDD,
VICE PRESIDENT FOR ADMINISTRATION AND FINANCE

SHEET NO: PAGE NO:

A 2 / 6







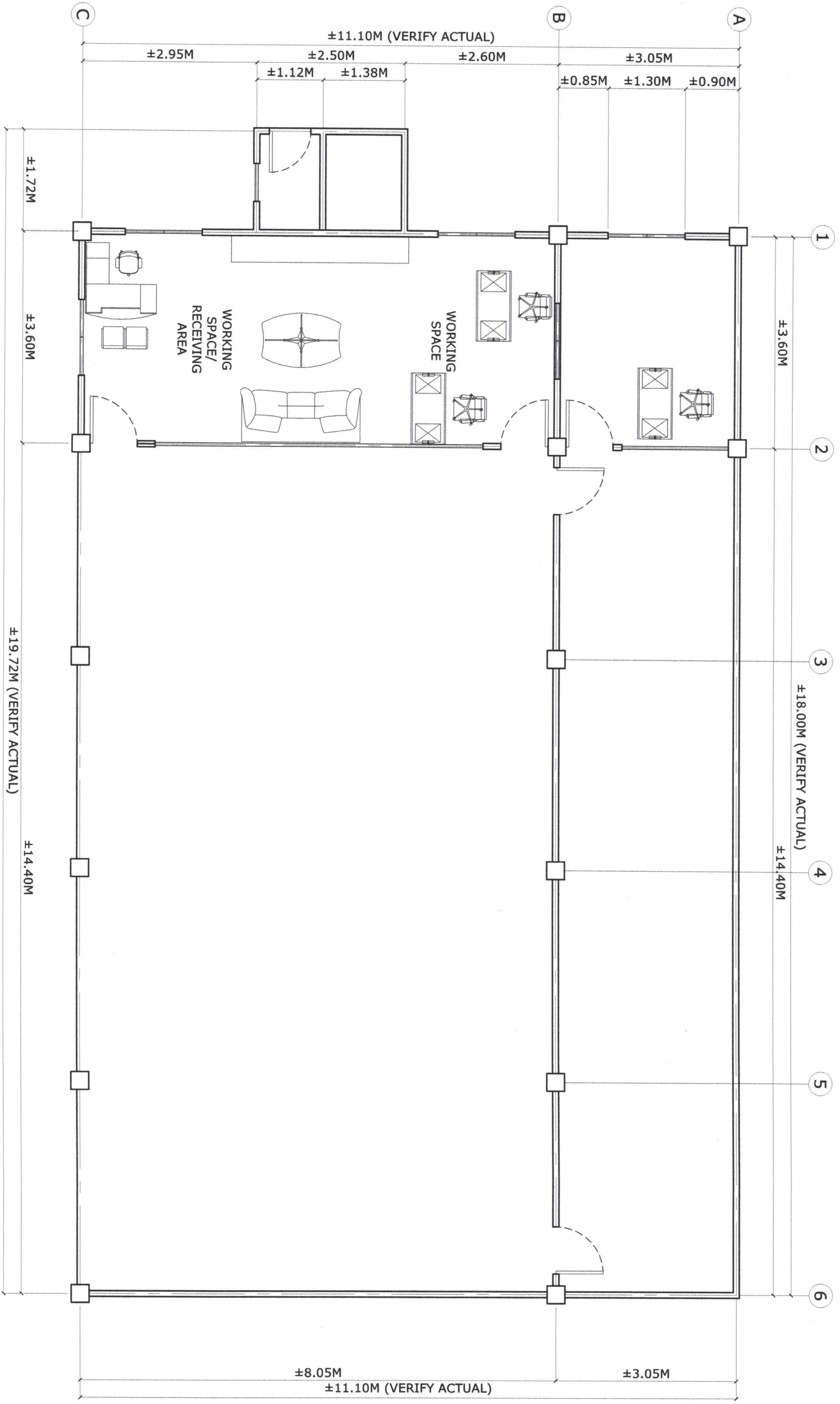

Republic of the Philippines
CARLOS HILADO MEMORIAL
STATE UNIVERSITY
Negros Occidental

PROJECT MANAGEMENT UNIT

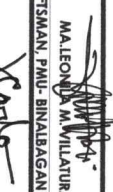





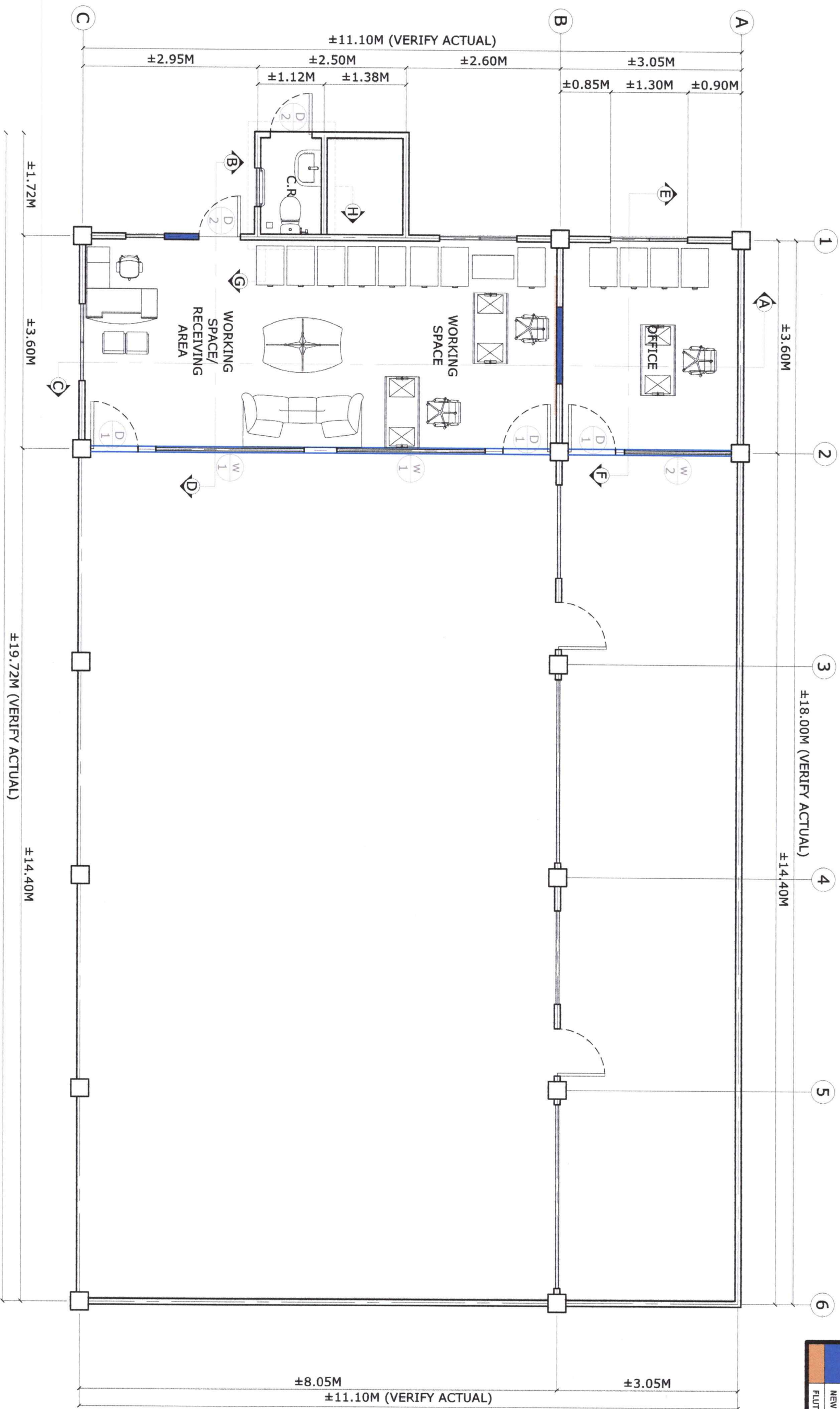

1
 EXISTING FLOOR PLAN
 SCALE 1:65 METERS
A3

| | | | | | | | | | | |
|--|--------------------------------|--|--|---|--|---|--|---|------------------------------|-----------------------------|
|  Republic of the Philippines CARLOS HILADO MEMORIAL STATE UNIVERSITY Negros Occidental | PROJECT MANAGEMENT UNIT | PROJECT TITLE: REPAIR AND ENHANCEMENT OF STUDENT CENTER (OSAS OFFICE) PHASE 2 AT CHMSU-BINALBAGAN CAMPUS | ENDORSED BY:  JOEVELLE B. VERGARA, EDD. EXECUTIVE DIRECTOR, BINALBAGAN | PREPARED BY:  MALEONDA M. WILLATIRA DRAFTSMAN, PMU- BINALBAGAN CAMPUS ENGR. JOHN CARLO F. GANON CIVIL ENGINEER, PMU- BINALBAGAN CAMPUS | CHECKED BY:  ARSENEL M. M. M. PROJECT DEVELOPMENT OFFICER II, PMU ENGR. DESIRE O. CHAVEZ PROJECT DEVELOPMENT OFFICER III, PMU | RECOMMENDING APPROVAL:  EJAYSON JUN J. M. M. DIRECTOR, PROJECT MANAGEMENT UNIT | APPROVED BY:  JAY B. ESTRELLA, EDD. VICE PRESIDENT FOR ADMINISTRATION AND FINANCE | APPROVED BY:  NORBERTO P. MANGULABNAN, PH.D. SUC PRESIDENT III | SHEET NO: A | PAGE NO: 3 |
|--|--------------------------------|--|--|---|--|---|--|---|------------------------------|-----------------------------|

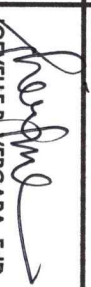

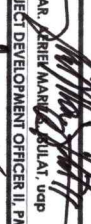
1 PROPOSED FLOOR PLAN
 SCALE: 1:65 METERS

| LEGEND | |
|--------|-------------------|
| | EXISTING CHB WALL |
| | NEW CHB WALL |
| | FUTED PANEL |

| | | | | | | | | | | | |
|--|--------------------------------|--|--|---|--|---|--|--|------------------------------|-----------------------------|-----------------------------------|
|  Republic of the Philippines CARLOS HILADO MEMORIAL STATE UNIVERSITY Negros Occidental | PROJECT MANAGEMENT UNIT | PROJECT TITLE: REPAIR AND ENHANCEMENT OF STUDENT CENTER (OSAS OFFICE) PHASE 2 AT CHMSU-BINALBAGAN CAMPUS | ENDORSED BY:  JOEVELLA B. VERGARA, EDD. EXECUTIVE DIRECTOR, BINALBAGAN | PREPARED BY:  MA LEONILA M. VILLALUNA DRAFTSMAN, PMU - BINALBAGAN CAMPUS | CHECKED BY:  AR. DESIRE O. CHAVEZ PROJECT DEVELOPMENT OFFICER II, PMU | RECOMMENDING APPROVAL:  ENGR. JAN-JUN J. MARQUEZ DIRECTOR, PROJECT MANAGEMENT UNIT | APPROVED BY:  JAY B. ESTRELLA, EDD. VICE PRESIDENT FOR ADMINISTRATION AND FINANCE | APPROVED BY:  NORBERTO P. MANJULAN, Ph.D. SUC PRESIDENT III | SHEET NO: A | PAGE NO: 4 | NO. OF SHEETS: 6 |
|--|--------------------------------|--|--|---|--|---|--|--|------------------------------|-----------------------------|-----------------------------------|

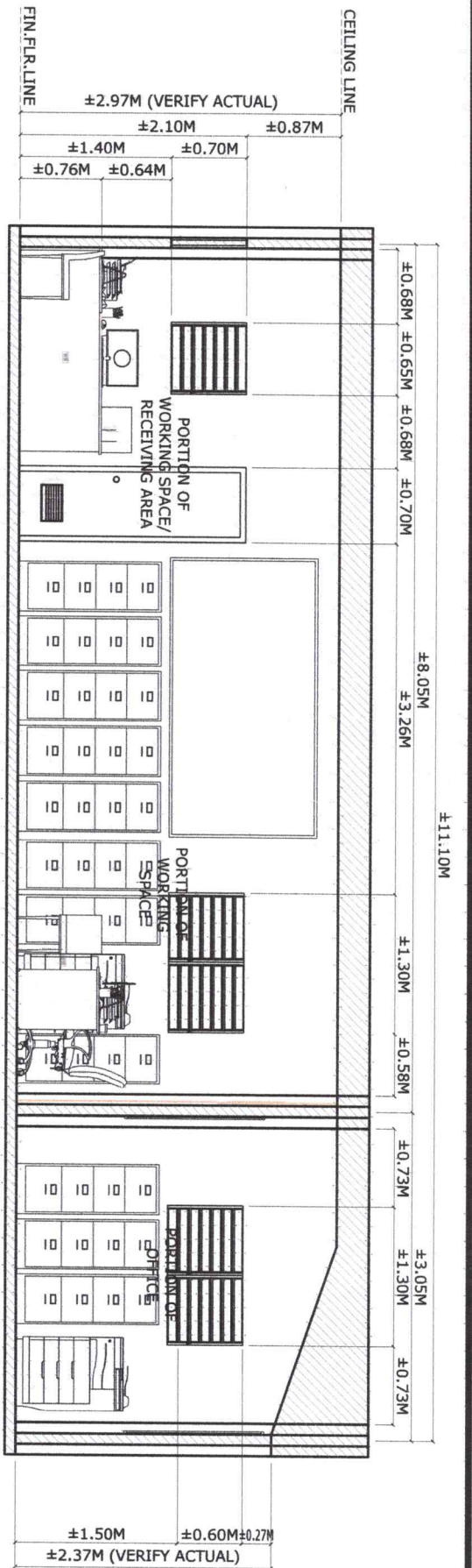

1 SECTION THRU-AA
SCALE 1:60 METERS

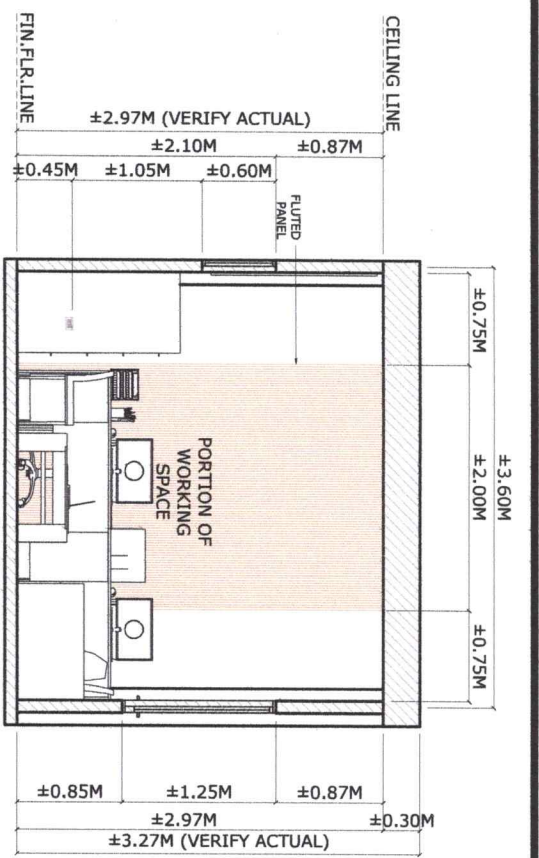

2 SECTION THRU-BB
SCALE 1:60 METERS

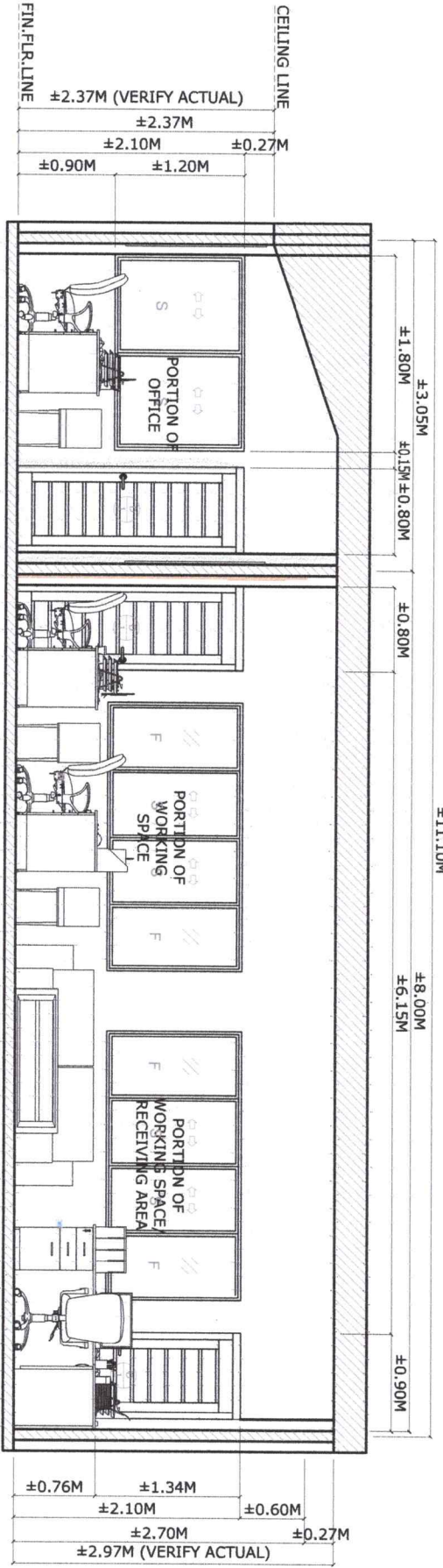

3 SECTION THRU-CC
SCALE 1:60 METERS

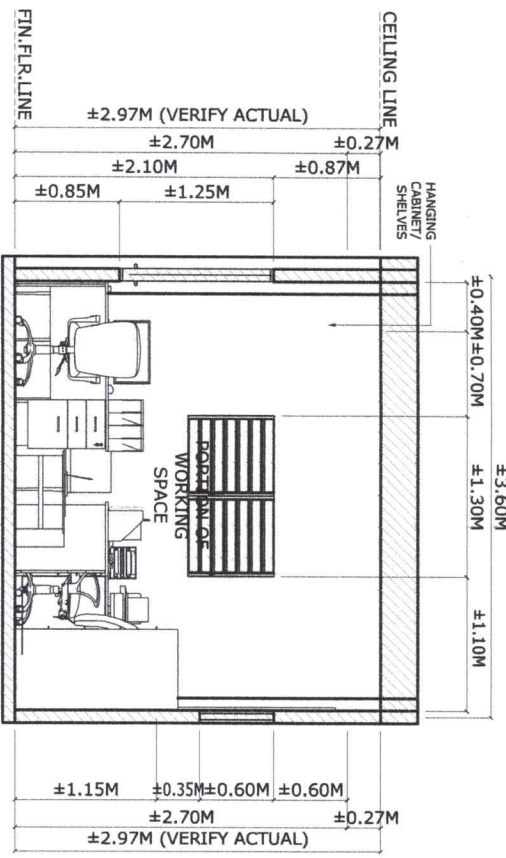

4 SECTION THRU-DD
SCALE 1:60 METERS

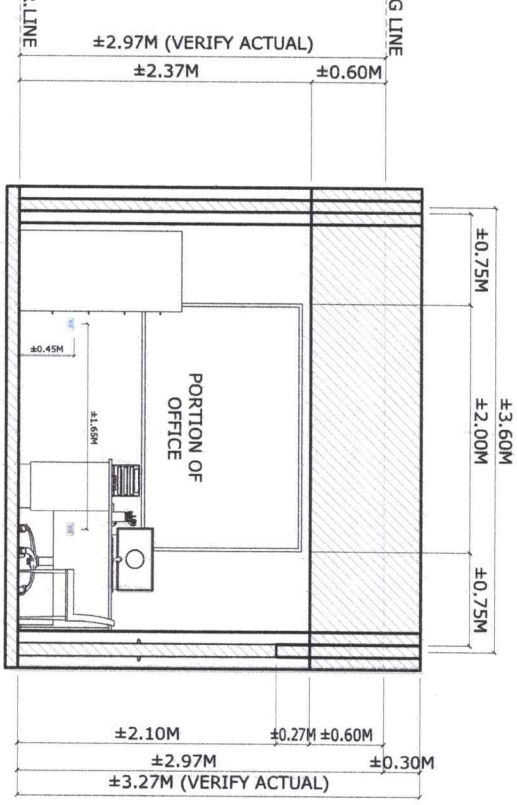

5 SECTION THRU-EE
SCALE 1:60 METERS

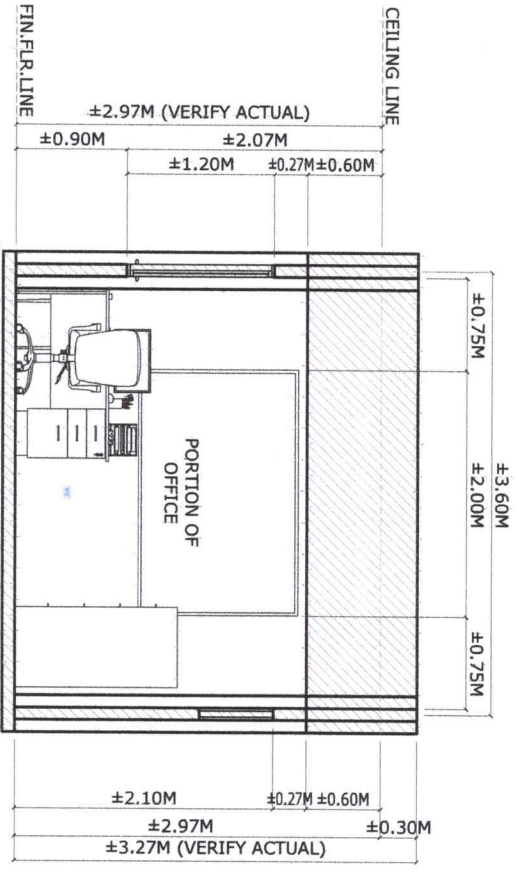



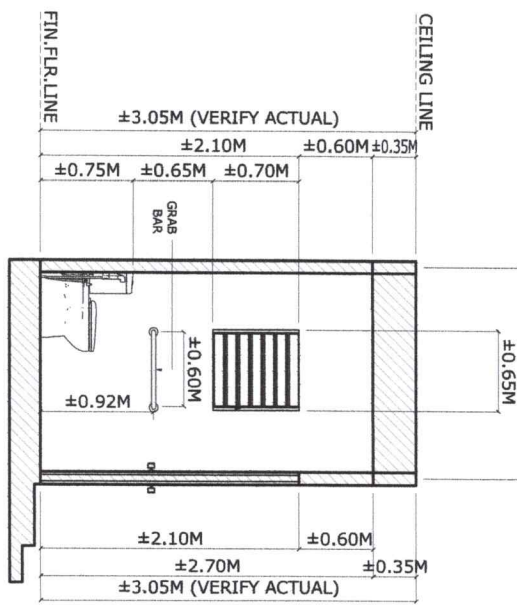

6 SECTION THRU-FF
SCALE 1:60 METERS

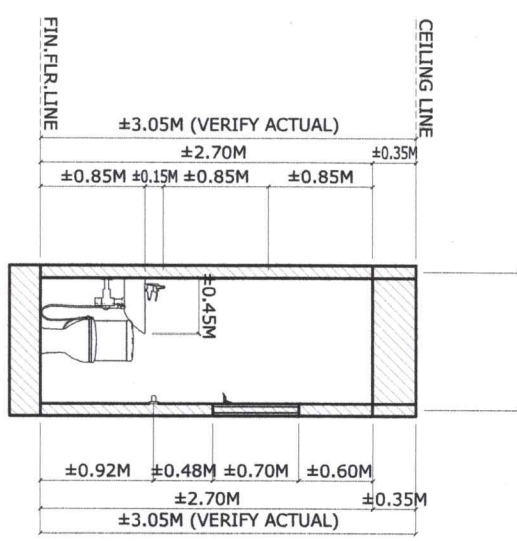

7 SECTION THRU-GG
SCALE 1:60 METERS

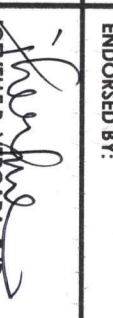

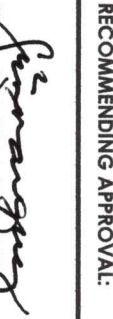
8 SECTION THRU-HH
SCALE 1:60 METERS

| | | | | | | | | | |
|---|--------------------------------------|--|---|--|---|--|---|--------------------|-------------------|
|  <p>Republic of the Philippines CARLOS HILADO MEMORIAL STATE UNIVERSITY Negros Occidental</p> | PROJECT MANAGEMENT UNIT | PROJECT TITLE: REPAIR AND ENHANCEMENT OF STUDENT CENTER (OSAS OFFICE) PHASE 2 AT CHMSU-BINALABAGAN CAMPUS | ENDORSED BY:  EXECUTIVE DIRECTOR, BINALABAGAN | PREPARED BY: MALEONIL M. ALIATIRA DRAFTSMAN, PMU- BINALABAGAN CAMPUS | CHECKED BY:  PROJECT DEVELOPMENT OFFICER II, PMU | RECOMMENDING APPROVAL:  DIRECTOR, PROJECT MANAGEMENT UNIT | APPROVED BY:  NORBERTO P. MANGULABAN, Ph.D. SUC PRESIDENT III | SHEET NO: A | PAGE NO: 5 |
| | PROJECT LOCATION: BINALABAGAN CAMPUS | JOEVELLE B. YENGARA, EDD. EXECUTIVE DIRECTOR, BINALABAGAN | ENGR. JOHN CARLO F. GANON CIVIL ENGINEER, PMU- BINALABAGAN CAMPUS | ENGR. JIMENE O. DIAZ PROJECT DEVELOPMENT OFFICER III, PMU | ENGR. JUN J. MORALES DIRECTOR, PROJECT MANAGEMENT UNIT | JAY B. ESTRELLAS, EDD. VICE PRESIDENT FOR ADMINISTRATION | | | |

| LOCATION | SIZE | NO. OF PANELS | NO. OF UNITS | MATERIALS | TYPE |
|--|-----------------------|------------------|-----------------|--|--------------------------------|
| LOCATION: MAIN DOOR/OFFICE | SIZE: 1.00 M X 2.10 M | NO. OF PANELS: 1 | NO. OF UNITS: 3 | MATERIALS: WOOD PANEL | TYPE: FLUSH DOOR |
| LOCATION: WORKING SPACE/COMFORT ROOM | SIZE: 0.70 M X 2.10 M | NO. OF PANELS: 1 | NO. OF UNITS: 2 | MATERIALS: POLYVINYL CHLORIDE (PVC) | TYPE: FLUSH DOOR |
| LOCATION: WORKING SPACE/RECEIVING AREA | SIZE: 2.50 M X 1.25 M | NO. OF PANELS: 4 | NO. OF UNITS: 2 | MATERIALS: GLASS & ALUMINUM W/ 1/4" THK. GLASS | TYPE: SLIDING AND FIXED WINDOW |
| LOCATION: OFFICE | SIZE: 1.90 M X 1.20 M | NO. OF PANELS: 2 | NO. OF UNITS: 1 | MATERIALS: GLASS & ALUMINUM W/ 1/4" THK. GLASS | TYPE: SLIDING WINDOW |

| CODE | DESCRIPTION |
|--------------|-------------------------------|
| DOOR 1 AND 2 | CHOCOLATE BROWN PAINT FINISH. |
| DOOR 3 | BROWN PVC |

| CODE | DESCRIPTION |
|-------------------------------|--|
| WALL FINISHED 1 (WALL ACCENT) | WALNUT INDOOR FLUTED PANEL (WOOD COMPOSITE MATERIAL) AND 12MM THK. FICEM BOARD AS BACKING (VERIFY PDDM OFFICE) |
| INTERIOR WALL | WINTER MORNING PAINT FINISH. |

1 SCHEDULE OF DOORS AND WINDOWS
SCALE: 1:50 METERS

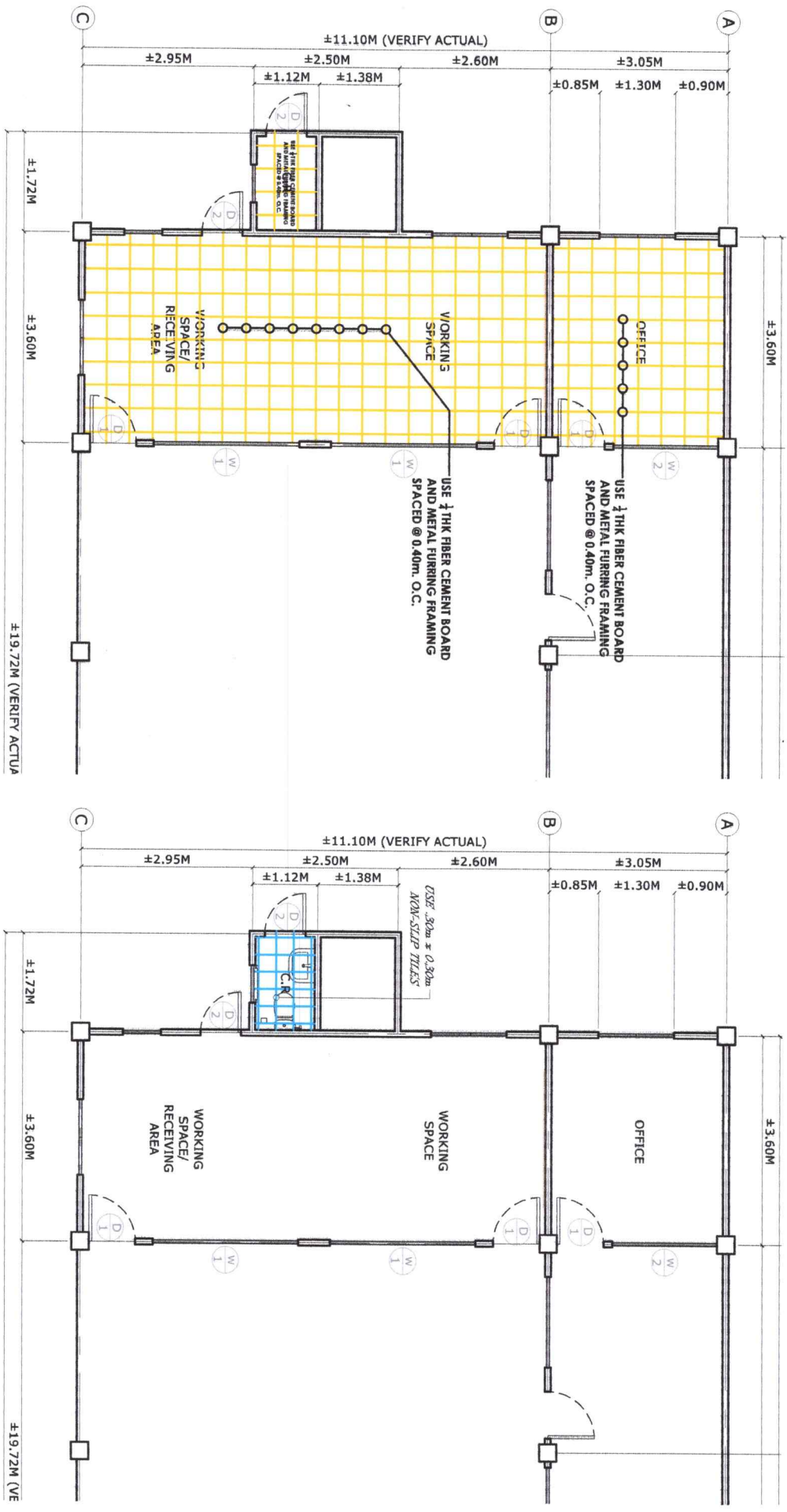

2 CEILING LAYOUT PLAN
SCALE: 1:100 METERS

3 COMFORT ROOM FLOOR TILES LAYOUT PLAN
SCALE: 1:100 METERS

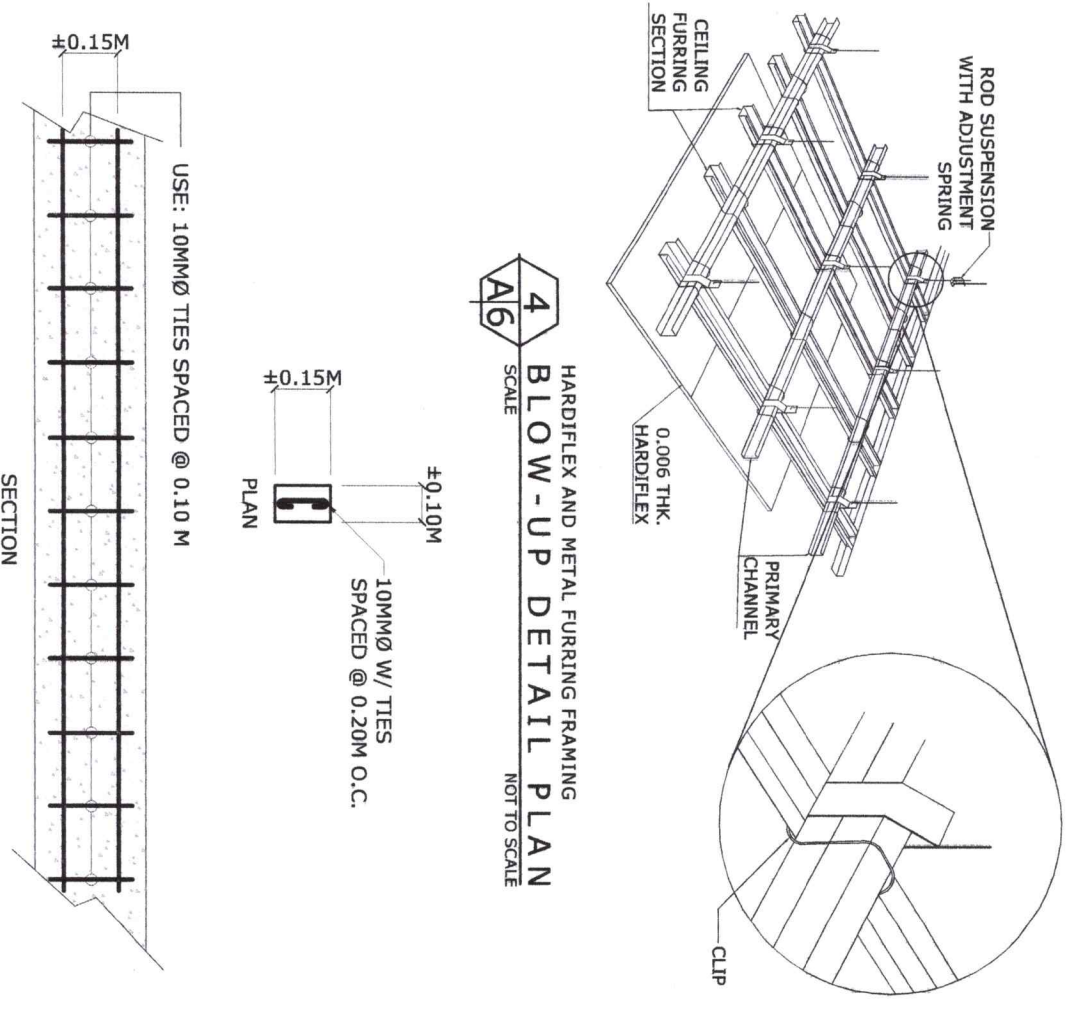

4 BLOW-UP DETAIL PLAN
SCALE: NOT TO SCALE

5 LINTEL BEAM DETAIL
SCALE: 1:20 METERS

Republic of the Philippines
CARLOS HILADO MEMORIAL STATE UNIVERSITY
Negros Occidental

PROJECT TITLE: REPAIR AND ENHANCEMENT OF STUDENT CENTER (OSAS OFFICE) PHASE 2 AT CHMSU-BINALBAGAN CAMPUS

PROJECT LOCATION: BINALBAGAN CAMPUS

PROJECT MANAGEMENT UNIT

| | | | |
|---|--|---|---|
| ENDORSED BY: | PREPARED BY: | CHECKED BY: | RECOMMENDING APPROVAL: |
| | | | |
| JOEVELLE B. VERGARA, EDD. EXECUTIVE DIRECTOR, BINALBAGAN | MALCOM M. MULARA DRAFTSMAN, PMU, BINALBAGAN CAMPUS | ARNEL M. ISULAT, up PROJECT DEVELOPMENT OFFICER II, PMU | ENGR. Jm. JUN J. MARIQUEZ DIRECTOR, PROJECT MANAGEMENT UNIT |
| ENDORSED BY: | APPROVED BY: | | |
| | | | |
| JAY B. ESPINILLAS, EDD. VICE PRESIDENT FOR ADMINISTRATION | NORBERTO P. MANGULABNAN, Ph.D SUC PRESIDENT III | | |

SHEET NO.: A

PAGE NO.: 6

PROJECT MANAGEMENT UNIT

PROJECT TITLE: REPAIR AND ENHANCEMENT OF STUDENT CENTER (OSAS OFFICE) PHASE 2 AT CHMSU-BINALBAGAN CAMPUS

GENERAL NOTES:

1. ALL WIRING INSTALLATIONS MUST CONFORM WITH THE LATEST REQUIREMENT OF THE PHILIPPINE ELECTRICAL CODE, NATIONAL BUILDING CODE, FIRE CODE OF THE PHILIPPINES AND THE REQUIREMENTS OF THE LOCAL ELECTRIC UTILITY.
2. THE SOURCE OF POWER IS FROM THE EXISTING POWER SUPPLY.
3. SERVICE ENTRANCE WIRE SHALL BE 2-14MM SQ. THW & 1-8MM SQ. THW (GROUND) IN 50MM (2" DIA.) RMC.
4. MAIN BREAKER SHALL BE 60A, 2P, 240V BOLT-ON TYPE.
5. NO WIRE SMALLER THAN 3.5MM SQ. THHN WIRE SHALL BE USED.
6. ALL WIRING INSTALLATION MUST BE SUPERVISED BY AT LEAST A LICENSED MASTER ELECTRICIAN AND MONITORED BY AN REE OR PEE.
7. NO WORK SHALL STARTED WITHOUT APPROVED BUILDING PERMIT.
8. ALL WORK MUST BE DONE AS REFLECTED ON THE APPROVED ELECTRICAL PLANS.

| SYMBOL | DESCRIPTION |
|--------|--------------------|
| — | ELECTRICAL WIRE |
| — | SWITCH LINE |
| ○ | PIN LIGHT |
| □ | PANEL BOARD |
| — | CIRCUIT HOME RUN |
| □ | CONVENIENCE OUTLET |
| □ | SINGLE SWITCH |
| □ | TWO-GANG SWITCH |
| □ | TWO-WAY SWITCH |
| □ | WEATHER PROOF |
| □ | AIR CONDITION UNIT |
| □ | EXHAUST FAN |
| □ | EMERGENCY LIGHT |

| SCHEDULE OF LOADS | | | | | | | | | |
|-------------------|----------|------|----------------------|--------|----------|-------|--------------------|--------------|------------------------------|
| PB1 | CKT. NO. | QTY. | DESCRIPTION | VA | VA TOTAL | VOLTS | AMPERES PROTECTION | SIZE OF WIRE | SIZE OF CONDUIT |
| | C1 | 5 | CEILING LIGHT OUTLET | 100 | 600 | 230 | 2.61 | 15A | 2-3.5MM2 THHN 20MM2 PVC PIPE |
| | C2 | 11 | CONVENIENCE OUTLET | 180 | 1980 | 230 | 8.61 | 30A | 2-5.5MM2 THHN 20MM2 PVC PIPE |
| | C3 | 1 | AIRCON OUTLET | 2.5 HP | 2331 | 230 | 10.13 | 30A | 2-5.5MM2 THHN 20MM2 PVC PIPE |
| | C4 | 1 | AIRCON OUTLET | 2.5 HP | 2331 | 230 | 10.13 | 30A | 2-5.5MM2 THHN 20MM2 PVC PIPE |
| | C5 | 1 | SPARE | 180 | 180 | 230 | 0.78 | 30A | 2-5.5MM2 THHN 20MM2 PVC PIPE |
| | C6 | 1 | SPARE | 180 | 180 | 230 | 0.78 | 30A | 2-5.5MM2 THHN 20MM2 PVC PIPE |
| | TOTAL | | | | 33.04 | | | | |

I = (33.04 X 1.25)
= 41.30 AMPERES
USE: 60A, 2P CIRCUIT BREAKER
14MM² THHN IN 2"Ø RCS +1-3.5MM(G)

1 GENERAL NOTES
SCALE: E1
NOT TO SCALE

2 LEGEND
SCALE: E1
NOT TO SCALE

3 SCHEDULE OF LOADS
SCALE: E1
NOT TO SCALE

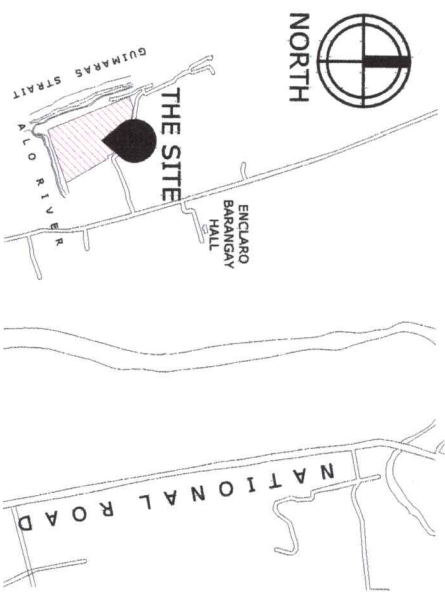

4 VICINITY PLAN
SCALE: E1
NOT TO SCALE

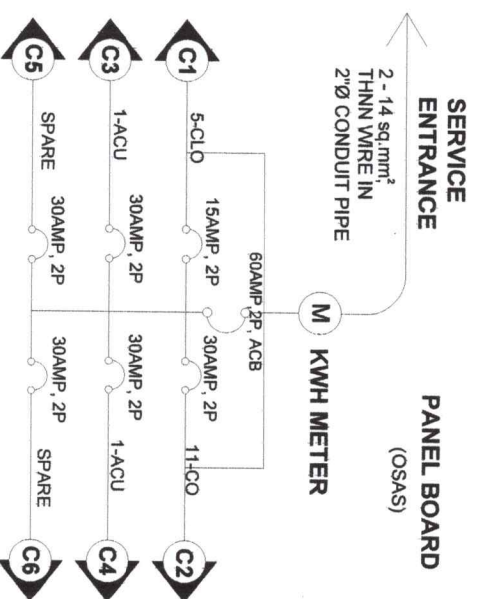

5 SINGLE LINE DIAGRAM
SCALE: E1
1:100 METERS

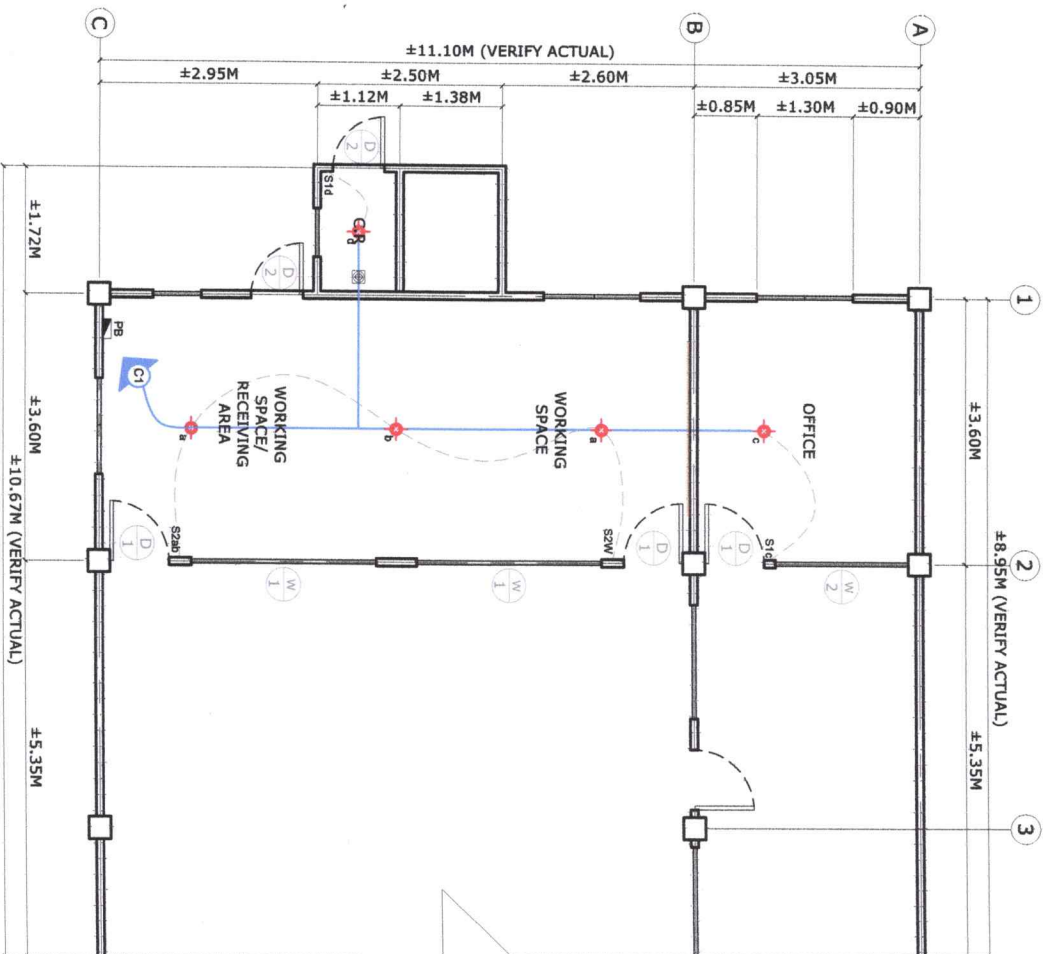

6 LIGHTING LAYOUT PLAN
SCALE: E1
1:100 METERS

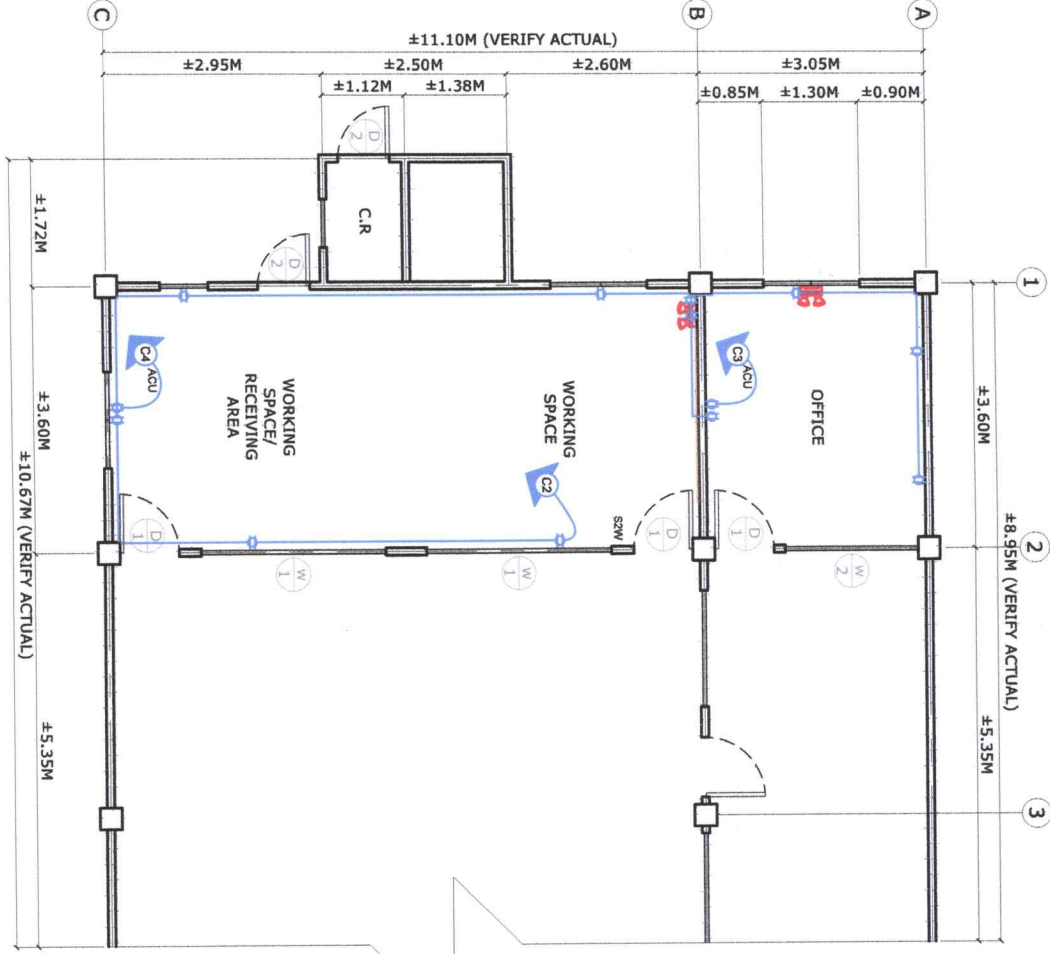

7 POWER LAYOUT PLAN
SCALE: E1
1:100 METERS

| | | | | | | | | | | | | | | | |
|--------------------------------|--|---|--|--|--|---|--|---|--|---|--|---|--|------------------------|-----------------------|
| | | PROJECT TITLE: REPAIR AND ENHANCEMENT OF STUDENT CENTER (OSAS OFFICE) PHASE 2 AT CHMSU-BINALABAGAN CAMPUS | | ENDORSED BY: JOVELLE B. VERGARA, EDD. EXECUTIVE DIRECTOR, BINALABAGAN | | PREPARED BY: MA. LEONILA M. ALIWA DRAHTSMAN, PMU, BINALABAGAN CAMPUS | | CHECKED BY: ENGR. PANFILO B. DESQUITRADO PROFESSIONAL ELECTRICAL ENGINEER, PMU | | RECOMMENDING APPROVAL: ENGR. DAN-JUN J. MAQUINEZ DIRECTOR, PROJECT MANAGEMENT UNIT | | APPROVED BY: NORBERTO P. MANGUALABNAN, PH.D. SUC PRESIDENT III | | SHEET NO.: E | PAGE NO.: 1 |
| PROJECT MANAGEMENT UNIT | | PROJECT LOCATION: BINALABAGAN CAMPUS | | CIVIL ENGINEER, PMU, BINALABAGAN CAMPUS ENGR. JOHN CARLO F. GANON | | PROJECT DEVELOPMENT OFFICER III, PMU ENGR. ESTRE O. CHAVEZ | | VICE PRESIDENT FOR ADMINISTRATION JAY B. ESTRELLAS, EDD. | | APPROVED BY: JAY B. ESTRELLAS, EDD. | | SUC PRESIDENT III NORBERTO P. MANGUALABNAN, PH.D. | | SHEET NO.: E | PAGE NO.: 1 |

GENERAL NOTES:

1. ALL SANITARY WORKS INCLUDE HEREIN SHALL BE EXECUTED ACCORDING TO THE PROVISIONS OF THE NATIONAL PLUMBING CODE OF THE PHILIPPINES, THE NATIONAL BUILDING CODE OF THE PHILIPPINES AND ITS IMPLEMENTING RULES AND REGULATIONS.
2. PROPOSED SANITARY UTILITIES SHALL CONFORM TO THE CRITICAL LOCATION, DEPTH AND INVERT ELEVATION OF EXISTING PIPES.
3. LOCATION: NO SEPTIC TANK SHALL BE INSTALLED WITHIN OR UNDER ANY STRUCTURE.
4. TANKS MUST BE BUILT WATER TIGHT OF CONCRETE, PRECAST OR BRICK STONE.
5. BOTH COMPARTMENTS ARE PROVIDED WITH MANHOLE AND TIGHT COVERS FOR CLEANING AND NECESSARY REPAIR.
6. ALL FIXTURES SHALL BE TESTED, UNLESS OTHERWISE NOTED.
7. COORDINATE THE DRAWING WITH OTHER RELATED DRAWINGS AND SPECIFICATION. THE ARCHITECT/AND OR ENGINEER SHALL BE NOTIFIED IMMEDIATELY OF ANY DISCREPANCY FOUND THEREIN, IMMEDIATELY OF ANY DISCREPANCY FOUND THEREIN, HIS/HER DECISION SHALL BE FINAL.

1 GENERAL NOTES
SCALE: NOT TO SCALE

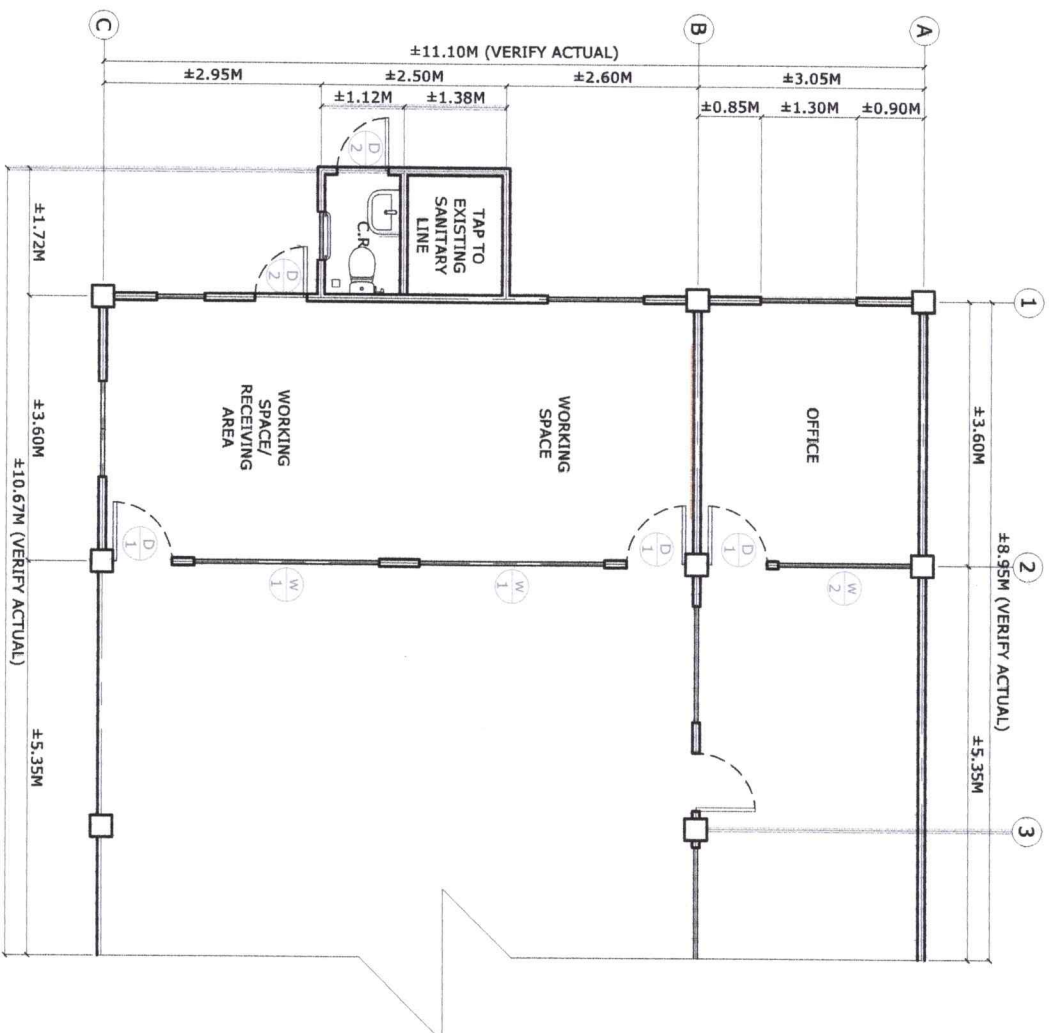

2 VICINITY PLAN
SCALE: NOT TO SCALE

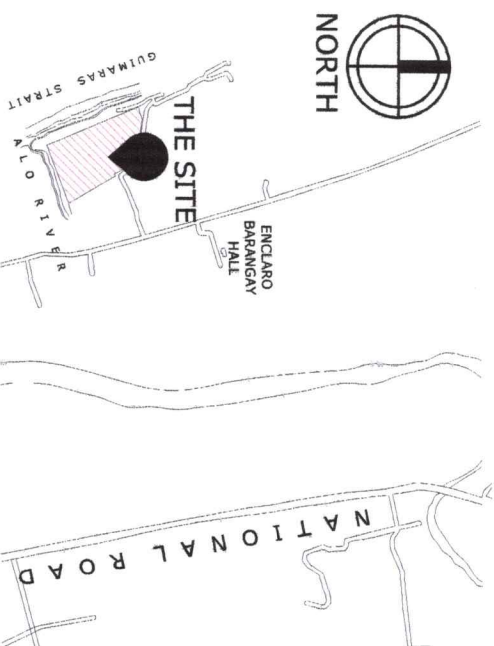

3 LEGEND
SCALE: NOT TO SCALE

| | |
|---|-------------------|
| — | SANITARY PIPE |
| — | WATER PIPE LINE |
| — | WATER SOURCE LINE |
| — | WATER METER |
| — | WATER CLOSET |
| — | KITCHEN SINK |
| — | FLOOR DRAIN |
| — | DIAMETER |
| — | FAUCET |
| — | CLEAN-OUT |
| — | VENT THRU ROOF |
| — | GREASE TRAP |

4 SANITARY LINE LAYOUT PLAN
SCALE: 1:100 METERS

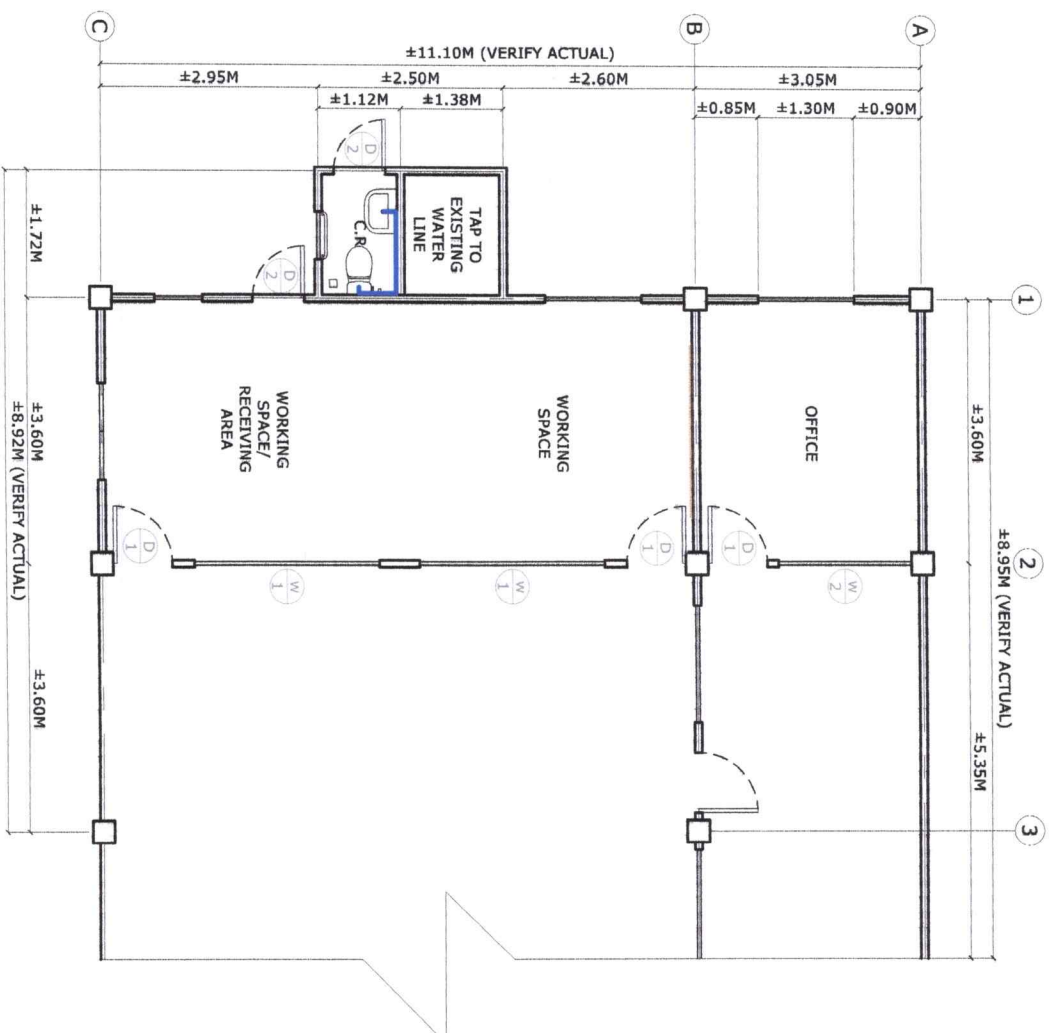

5 WATER LINE LAYOUT PLAN
SCALE: 1:100 METERS

| | | | | | | | | |
|--|--|---|---|---|--|---|---|-----------|
| <p>Republic of the Philippines CARLOS HILADO MEMORIAL STATE UNIVERSITY Negros Occidental</p> | PROJECT TITLE: | ENDORSED BY: | PREPARED BY: | CHECKED BY: | RECOMMENDING APPROVAL: | APPROVED BY: | SHEET NO.: | PAGE NO.: |
| | REPAIR AND ENHANCEMENT OF STUDENT CENTER (OSAS OFFICE) PHASE 2 AT CHMSU-BINALABAGAN CAMPUS PROJECT LOCATION: BINALABAGAN CAMPUS | JOVELLE B. VARGARA, EDD. EXECUTIVE DIRECTOR, BINALABAGAN | MALEONIL M. VILLATURBA DR. ATSMAN, PMU- BINALABAGAN CAMPUS ENGR. JOHN CARLO F. GANON CIVIL ENGINEER, PMU- BINALABAGAN CAMPUS | AP. KENEL M. ISILAT, upp PROJECT DEVELOPMENT OFFICER II, PMU ENGR. DANIEL O. CHAVEZ PROJECT DEVELOPMENT OFFICER III, PMU | ENGR. JUN-JUN J. MABUQUEZ DIRECTOR, PROJECT MANAGEMENT UNIT | JAY B. ESTRELLAS, EDD. VICE PRESIDENT FOR ADMINISTRATION | NORBERTO P. MANGULABNAN, Ph.D. SUC PRESIDENT/III | P 11 |